



2015 Edition

Product Catalogue



- Hand Pumps
- Oil Transfer Equipment
- Fuel Transfer Equipment
- UREA/DEF Equipment
- Grease Equipment
- Workshop Equipment
- Ancillary Equipment

Lubrication & Fuel Transfer Equipment



Company Profile

STM Australia Pty Ltd is an Australian owned company that manufactures and markets Lubrication and Workshop Equipment.

Our Lubrication and Workshop Equipment consists of Hand, Air and Electric Operated Pumps for use with liquid fuels and lubricants as well as providing other accessories including Hose Reels, Oil Meters, Fuel Nozzles and Greasing Equipment. STM aims to provide its customers with quality and reliable products, setting delivery standards above our competitors.

STM positioned itself as a prominent company in 1952 when it produced its first screwthread to today becoming one of Australia's leading manufacturer and distributor of Lubricant Dispensing Equipment.

STM's success has not happened by chance. Our positive attitude, Engineering Excellence, and our ability to incorporate new and innovative design methods have placed STM products in high demand, allowing us to extend our markets here and overseas.

Our Head Office and manufacturing is located in Melbourne, Victoria Australia with sales offices in Sydney, Brisbane, Adelaide, Perth, and Auckland supported by regional stockists and distributors throughout rural Australia and New Zealand.

STM have certainly come a long way since those early screwthread days, foreseeing the sophisticated future needs of our industries. We look forward to meeting and exceeding all the challenges that lie ahead of us.

Hand Pumps

P3-16

- 1 Litre Tom Thumb Oil Pump
- 20 Litre Hand Pumps
- 60 Litre Hand Pumps
- 205 Litre Hand Pumps
- Suction gun & Oil Can
- Hand Cleaner Pumps
- Hand Pump Accessories

P3
P3-6
P6-7
P7-13
P14-15
P15
P15-16



Oil Transfer Equipment

P19-44

- Air Operated Oil Pumps
- Electric Oil Pump Motors
- Oil Transfer Tank Systems
- Diaphragm Pumps
- Hose Reels
- Oil Control Guns / Meters
- Drip Tray, Oil Bar & Accessories

P19-28
P28
P29
P32-33
P34-37
P38-42
P30-31, 43-44



Fuel Transfer Equipment

P47-60

- Fuel Transfer Pump Motors & Kits
- Tank Systems
- Hose Reels
- Flow Meters
- Fuel Nozzles
- Fuel Transfer Accessories

P47-50
P51-52
P53
P54
P55-57
P51, 58-60



UREA/DEF Equipment

P63-67

- UREA/DEF IBC Pump System
- UREA/DEF Electric Pumps
- UREA/DEF Diaphragm Pump
- UREA/DEF Hose Reel
- UREA/DEF Meters & Nozzles
- UREA/DEF Hand Pumps
- UREA/DEF Accessories

P63
P64-65
P65
P65
P66
P67
P67



Grease Equipment

P71-88

- Grease Guns
- Grease Units
- Grease Control Gun
- Air Operated Grease Pumps
- Grease Accessories
- Grease Nipples

P71-73
P73-74
P75
P75-79
P80-83
P84-88



Workshop Equipment

P91-100

- Oil Drainers
- Drum Trolleys
- Spill Containment
- Drum Racks & Brake Bleeder
- Storage Tanks & Gantry System
- Workshop Accessories

P91-93
P93-95
P95-96
P96-97
P98-99
P100



Ancillary Equipment

P103-115

- Replacement Parts
- Air Regulators, Lubricators & Taps
- Adaptors, Hose Kits, Spanners & Oil Jugs
- Farm Tank Equipment
- Valves
- Camlock Fittings

P103-104
P104-105
P105-110, 117
P111-113
P113-114
P114-116



Appendix

P119-125

- Conversion factors
- Marketing Support
- Online Webstore
- Fax Order Form
- Application For Credit Account
- Terms & Conditions

P119-120
P121
P122
P123
P124
P125



HAND PUMPS



1 LITRE

NEW
HIGH
VOLUME

www.stm.net.au

www.stm.net.au



Hand Pumps

P3-16

Tom Thumb Oil Pump

- 1 Litre Tom Thumb Oil Pump

P3-3

P3



20 Litre Hand Pumps

- Oil
- ATF
- Coal Mining
- Break Fluid
- Multi Purpose
- Chemical

P3-6

P3-4

P4

P4

P5

P5

P6



60 Litre Hand Pumps

- Oil
- ATF
- Multi Purpose
- Chemical

P6-7

P6

P6-7

P7

P7



205 Litre Hand Pumps

- Oil
- Chemical
- Multi Purpose
- Fuel

P7-13

P7-9

P9-12

P10-11

P12-13



Hand Pump - Other

- Oil Suction Gun
- Oil Can
- Tom Thumb Hand Cleaner Pumps

P14-15

P14

P14

P15



Hand Pump Accessories

- Extension Tube
- Thread Adaptors

P15-16

P15

P15-16



Oil Transfer Pumps

1 Litre Tom Thumb Oil Pump

MODEL CA586

- 1 litre top up utility pump
- Ideal for hard to get to oiling points
- 10ml per stroke
- Suitable for oils, ATF and brake fluid
- Typically used for: Outboard and two stroke motors, chain saws, motor vehicles and odd jobs around the home

Product Features:

- Integrated carry handle
- 500mm long PVC hose and spout
- Aluminium construction
- Nylon head and handle
- Nozzle drain back holder



Nozzle Holder

Stops oil leaking from the spout. Nozzle drain back holder



Carry Handle

Easy mobility



Downstroke Action

Easy pumping with a spring operated return.

20 Litre Gear Oil Pump

MODEL CA465G2

- Easy down stroke displacement
- Approximately 14 strokes per litre
- Suitable for gear oil, engine oil and hydraulic oil
- 1.5 metre anti-kink hose
- Fitted with anti-drip nozzle and drain back nozzle holder
- Ground shaft with 'O' ring seal
- Nylon head and handle
- Special threaded adaptor designed and engineered to suit most plastic and metal drums
- Telescopic extension
- Suitable for rieke adaptor (CB274 series - page 16)
- 2 year warranty



Telescopic Tube

Find the depth of the drum with ease to draw the last drop of oil



O'ring Seal

Unique design to allow suction tube to seal properly



Nozzle Holder

Drainback hole fitted with o'ring that secures spout to prevent unwanted moisture, dust and dirt contaminating the oil



20 Litre Hand Pumps



20 Litre Spring Operated Oil Pump

MODEL CA480G

- Approximately 3.5 strokes per litre
- Unique spring actuated displacement
- 1.5 metre anti-kink hose
- Lever operated trigger nozzle and drain back nozzle holder
- Die cast head
- Replaceable gland packing seal
- 2¼" (57mm) 8 TPI bottle thread adaptor
- Australian made
- 2 year warranty



20 Litre ATF Pump

MODEL CA465ATF2

- Easy downstroke displacement
- Approximately 14 strokes per litre
- 1.5 metre anti-kink hose
- Fitted with anti-drip nozzle and drain back nozzle holder
- Ground shaft with 'O' ring seal and telescopic extension
- Nylon head and handle
- Special threaded adaptor designed and engineered to suit most plastic and tin plate drums
- Replaceable stainless steel mesh filter (100 x 41 SWG) which prevents contamination of system
- 2 year warranty
- Optional: Rieke drum thread adaptor to suit different drums (page 16)



20 Litre Spring Operated ATF Pump

MODEL CA480AFT

- Approximately 3.5 strokes per litre
- Unique spring actuated displacement
- 1.5 metre anti-kink hose
- Fitted with lever operated trigger nozzle and drain back nozzle holder
- Replaceable stainless steel mesh filter (100 x 41 SWG) which prevents contamination of system
- Replaceable gland packing seal
- 2¼" (57mm) 8 TPI bottle thread adaptor
- Australian made
- 2 year warranty



20 Litre Coal Mining Oil Pump

MODEL CA465GCM2

- For underground mining use
- Easy downstroke displacement
- Approximately 14 strokes per litre
- 1.5 metre anti-kink hose
- Fitted with anti-drip nozzle and drain back nozzle holder
- Ground shaft with 'O' ring seal
- Nylon head and handle
- Special threaded adaptor designed and engineered to suit most plastic and tin plate drums
- Telescopic extension
- 2 year warranty



20 Litre Hand Pumps



20 Litre Brake Fluid Pump

MODEL CA478BF

- Approximately 10 strokes per litre
- Durable hose suitable for brake fluid & drain back nozzle holder
- Special pump head design to prevent contamination of fluid
- Nylon head and handle
- Replaceable gland packing seal
- Stainless steel shaft
- Up stroke action
- 2¼" (57mm) 8 TPI bottle thread adaptor
- Australian made
- 2 year warranty



20 Litre Spring Operated Ratio Pump

MODEL CA485

- Two stroke oil dispensing pump with variable stroke
- Unique spring actuated displacement
- 3 preselected ratios per 5 litres as follows:
24 (209ml), 32 (156ml), 50 (100ml)
- 400mm anti-kink hose
- Fitted with anti-drip nozzle and drain back nozzle holder
- Diecast head and ground shaft with gland packing seal
- 2¼" (57mm) 8 TPI bottle thread adaptor
- Australian made
- 2 year warranty



20 Litre Multi Purpose Pump

- Up stroke action
- Nylon head and handle
- Replaceable gland packing seal
- Suitable for light oils, petrol, kerosene, thinners and solvents
- 2¼" (57mm) 8 TPI thread adaptor
- 2 year warranty
- Australian made

MODEL	CA478	CA476
Strokes per litre	10	10
Drum application	20 litre drum	20 litre drum
Construction	Stainless steel shaft & spout	Stainless steel shaft & spout
Hose	1.5 metre anti-kink hose	-
Nozzle	Yes	-
Nozzle drain back holder	Yes	-



60 Litre Hand Pumps



20 Litre Chemical Pump

MODEL DANZ255

- Suits 20 to 25 litre container
- Made from polypropylene
- Anti pumping child safety device fitted
- 5 container cap fittings available
- Suitable for pumping cleaning chemicals - chlorine based products, liquid fertiliser and crop chemicals
- Output per stroke: approximately 180ml
- Not suitable for highly flammable liquids



60 Litre Gear Oil Pump

MODEL CA467G2

- Easy down stroke displacement
- Approximately 14 strokes per litre
- 1.5 metre anti-kink hose
- Fitted with anti-drip nozzle and drain back nozzle holder
- Ground shaft with 'O' ring seal
- Nylon head and handle
- 2" bung thread
- 2 year warranty



60 Litre Spring Operated Oil Pump

MODEL CA469G

- Approximately 2 strokes per litre
- Unique spring actuated displacement
- 1.5 metre anti-kink hose
- Lever operated trigger nozzle and drain back nozzle holder
- Die cast head
- Ground shaft with 'O' ring seal
- 2" bung thread
- Australian made
- 2 year warranty



60 Litre ATF Pump

MODEL CA467ATF2

- Easy down stroke displacement
- Approximately 14 strokes per litre
- 1.5 metre anti-kink hose
- Fitted with anti-drip spout and drain back nozzle holder
- Ground shaft with 'O' ring seal
- Replaceable stainless steel mesh filter (100 x 41 SWG) which prevents contamination of system
- 2" bung thread
- 2 year warranty



60 Litre Hand Pumps



60 Litre Spring Operated ATF Pump

MODEL CA469ATF

- Approximately 2 strokes per litre
- Unique spring actuated displacement
- 1.5 metre anti-kink hose
- Fitted with lever operated nozzle and drain back nozzle holder
- Replaceable stainless steel mesh filter (100 x 41 SWG) which prevents contamination of system
- Ground shaft with 'O' ring seal
- 2" bung thread
- Australian made
- 2 year warranty



60 Litre Multi Purpose Pump

- Up stroke action
- Nylon head and handle
- Replaceable gland packing seal
- Suitable for light oils, petrol, kerosene, thinners and solvents
- 2" bung thread
- Australian made
- 2 year warranty
- 1.5 metre anti-kink hose and nozzle drain back holder (model no. CA 479)

MODEL	CA479	CA477
Stroke per litre	10	10
Drum application	60 litre drum	60 litre drum
Construction	Stainless steel shaft	Stainless steel shaft
Hose	1.5 metre anti-kink hose	-
Nozzle	Yes	-
Nozzle drain back holder	Yes	-



205 Litre Fuel Hand Pump

MODEL DA404

- High Flow up to 40 litres per minute
- 1 litre per stroke
- Suitable for diesel, petrol, kerosene and light oils up to SAE 30
- Lever action
- Solid aluminium construction with steal suction pipe
- Steel suction pipe and foot strainer
- Lockable handle
- Suitable for 60 and 205 litre drums



205 Litre Hand Pumps



DA01JW216



DA01JW214

205 Litre Rotary Pump

- Rotary action
- 3 piece steel suction pipe
- Suitable for motor oil & diesel
- 2" bung adaptor
- Not recommended for gear oil or petrol

MODEL	DA01JW216	DA01JW214
Revolutions per litre	3	3
Drum application	60 or 205 litre drum	60 or 205 litre drum
Hose length	1.5 metre	-
Nozzle	Yes	-
Construction	Solid cast iron	Solid cast iron



205 Litre Lever Oil Pump

MODEL DA2690

- Approximately 3 strokes per litre
- Lever action
- Light weight aluminium construction
- Swivel non-drip spout
- Telescopic suction pipe
- 2" bung thread



205 Litre Heavy Duty Lever Oil Pump

MODEL DA495

- Heavy duty lever action pump
- Approximately 400ml per stroke
- Zinc diecast construction
- Multi-directional handle
- Telescopic suction pipe
- 2" bung thread
- Swivel non-drip spout

205 Litre Hand Pumps



205 Litre Lever Oil Pump

MODEL DA826

- Approximately 2 strokes per litre
- Lever action
- Solid die cast construction
- Telescopic suction pipe
- Non-drip spout as shown or spout for hose diameter 3/4"
- 2" bung thread



DA492

205 Litre Lever Oil Pump

- Lever action
- Variable handle setting for various viscosity fluids
- Built in drum bung opener on pump head
- Telescopic suction tube suitable for 60 and 205 litre drums



DA491

MODEL	DA492	DA491
Stroke per litre	4	4
Drum application	60 or 205 litre drum	60 or 205 litre drum
Construction	Diecast head	Diecast head
Hose	Transparent 1.5 metre anti-kink hose	-
Nozzle	Yes	-



205 Litre Plastic Syphon Pump

MODEL DA606

- Plastic syphon pump
- Approximately 4 strokes per litre
- Lightweight Polyethylene
- Suitable only for some solvents and chemicals
- Check with STM for solvent compatibility data



205 Litre Hand Pumps

205 Litre Multi Purpose Pump

- Lever action
- Lightweight and economical
- Telescopic suction tube suitable for 60 and 205 litre drums



MODEL	DJPP200LP	DJPPS200LP	DJRST200LP	DJTS200LP
Strokes per litre	4	4	4	4
Construction	Polypropylene	Polypropylene	Ryton	Teflon
Shaft	Plated steel	Stainless steel	Stainless steel	Stainless steel
Teflon component	-	-	-	Yes
Suitable for:				
Lubrication oils	Yes	Yes	Yes	Yes
Petrol	Yes	Yes	Yes	Yes
Diesel	Yes	Yes	Yes	Yes
Some chemicals	Yes	Yes	Yes	Yes
Alcohol	Yes	Yes	Yes	Yes
Kerosene	Yes	Yes	Yes	Yes
Engine coolant	Yes	Yes	Yes	Yes
	Yes	Yes	Yes	Yes
Water based chemicals	-	Yes	Yes	Yes
Acid	-	Yes	Yes	Yes
Alkaline solutions	-	Yes	Yes	Yes
Water	-	Yes	Yes	Yes
Nitric acid	-	-	Yes	Yes
Aggressive liquids (check a compatibility chart)	-	-	-	Yes

205 Litre Hand Pumps

205 Litre Plastic Rotary Pump

- Rotary action
- Lightweight
- 3 piece suction pipe
- 2" bung adaptor
- Outlet rotatable 360°



DJPP200RP



DJR200RP

MODEL	DJPP200RP	DJR200RP
Revolutions per litre	3	3
Construction	Polypropylene	Ryton
Suitable for:	Acid, alkaline etc.	Aggressive chemicals
Acid	Yes	Yes
Alkaline	Yes	Yes
Alcohol	Yes	Yes
UREA/DEF	Yes	Yes
Some chemicals	Yes	Yes
Diesel	Yes	Yes
Water	Yes	Yes
Machine oil	Yes	-
Thinners	-	Yes



205 Litre Chemical Pump

MODEL DANZ20050

- Suits 100 to 205 litre container
- Approximately 400ml per stroke
- Made from PVC and polypropylene
- Easy pumping action - only 2 moving parts
- Anti pumping/child safety device fitted
- 4 drum attachment fittings available
- Suitable for pumping cleaning chemicals - chlorine based products, liquid fertiliser and crop chemicals
- Not suitable for highly flammable liquids



205 Litre Hand Pumps



205 Litre Stainless Steel Chemical Pump

MODEL DA300316

- Approximately 2 strokes per litre
- Lift action
- 316 Stainless steel body to suit more corrosive liquids
- Teflon seals
- Ideal for transferring soluble, corrosive, volatile and aggressive chemicals and medium viscosity petroleum based fluids
- 2" bung adaptor



205 Litre Stainless Steel Chemical Pump

MODEL DA490S

- Approximately 3 strokes per litre
- Lever Action
- 304 Stainless steel body
- Teflon seals
- Ideal for transferring soluble, corrosive, volatile and aggressive chemicals and petroleum based fluids
- 180° rotating spout
- Telescopic suction tube
- 2" bung thread



205 Litre Rotary Pump

- Rotary action
- 3 piece steel suction pipe
- Suitable for motor oil, diesel & petrol
- 2" bung adaptor

MODEL	DARP80H	DARP80
Revolutions per litre	3	3
Drum application	60 or 205 litre drum	60 or 205 litre drum
Hose length	1.5 metre	-
Nozzle	Yes	-
Construction	Aluminium	Aluminium

205 Litre Hand Pumps

205 Litre High Flow Rotary Pump

- Rotary action
- Solid aluminium construction
- 2 piece steel suction tube and foot strainer
- Suitable for diesel, petrol and oils up to SAE 30
- 2" bung adaptor
- DA02LP32FA - Equipped with 10 micron filter and clear bowl with water displacement valve (DBNS10)



MODEL	DA02LP32	DA02LP32HA	DA02LP32FA
Revolutions per litre	1	1	1
Drum application	60 & 205 litre drum	60 & 205 litre drum	60 & 205 litre drum
Hose	Plastic hose	Rubber hose with reinforced springs	Rubber hose with reinforced springs
Hose length	2 metre	2 metre	2 metre
Nozzle	-	Yes	Yes
Construction	Aluminium	Aluminium	Aluminium
Fuel filter (DBNS10)	-	-	Yes



Suction Gun & Oil Can



Oil Suction Gun

- 500ml transfer suction pump with durable plunger
- One way / Two way hose for suction and discharge of fluids
- Also for draining oils and other fluids
- Self priming & easy to operate
- Ideal for farm, automotive, home and factory use
- Suitable for diesel, oil, brake fluid, ATF, Power steering fluid and coolant
- DKCO-502 - Durable check valve ideal for emergency fuel transfer directly from one vehicle to another

MODEL	DKCO-501	DKCO-502
Capacity	500ml	500ml
Hose outlets	One way	Two way
Hose length	500mm	750mm
Check valve	-	Yes
Construction	Aluminium	Aluminium

Oil Can

- 500ml oil can
- Easily lubricate machinery
- Great for around the home or on the farm



MODEL	DO51371	DO51370
Capacity	500ml	500ml
Spout	Rigid	Flexible
Construction	Metal	Metal

Hand Cleaner Pumps

Tom Thumb Hand Cleaner Pumps

- Up stroke action
- Lightweight
- Australian Made
- Suitable for 5 - 20 litre containers
- Nylon head and handle
- Contact STM for custom sizes



MODEL	Drum Application	Adaptor	Adaptor Type	Material Showing	Container Depth	Construction
CA574	4 Litre container	1¼"	Plastic	186mm	194mm	Aluminium
CA574N	2.5 Kg container	1¼"	Plastic	170mm	187mm	Aluminium
CA575	20 Litre container	1¼"	Plastic	331mm	350mm	Aluminium
CA576	20 Litre container	2¼"	Tin lid	363mm	380mm	Aluminium
CA578	20 Litre container	1½"	Plastic	272mm	350mm	Stainless steel
CA599	20 Litre container	58mm	Plastic	326mm	325mm	Stainless steel



Extension Tube

MODEL CB465T

- Plastic extension tube
- Used to find the depth of the drum to draw every last drop of fluid
- Provides an extra 110mm length to pump
- Fits 20 & 60 litre hand pumps with 25mm diameter suction tube



20 Litre Rieke Snap On Drum Adaptor

MODEL CB274S

- 20 Litre drum adaptor to suit containers with no thread on closure
- Female snap on opening of 40mm
- Male Thread 2¼"
- Available in Blue only

20 Litre Rieke Drum Thread Adaptors

- 20 Litre rieke drum thread adaptor
- Easily adapts to various 20 litre drums
- Available in various sizes
- Single & 2 start threads
- Different colours to easy identify

CB274



CB274Y



CB274BK



CB 274G



CB274R



MODEL	CB274	CB274Y	CB274G	CB274R	CB274BK
Male thread	2¼"	2¼"	2¼"	2¼"	2¼"
Female opening I.D.	38mm	36mm	33mm	35mm	40mm
Thread start	1	2	2	1	1
Colour	Grey	Yellow	Green	Red	Black

OIL TRANSFER EQUIPMENT



OIL TRANSFER
EQUIPMENT



Table of Contents

Oil Transfer Equipment

P19-44

Air Operated Oil Pumps

- 1:1 Oil Pumps
- 3:1 Oil Pumps
- 5:1 Oil Pumps
- 5:1 High Volume Oil Pumps Accessories
- Oil Pump Bar
- Wall Mounted Oil Pump Kit
- Oil Pump Kit
- 3:1 Portable Oil Pump Kits
- 5:1 Portable Oil Pump Kits
- Oil Dispenser

P19-28

P19
P20
P21-22
P22
P23
P24
P25
P26
P27
P28



Electric Oil Pump Motors

- 240 Volt Gear Oil Pump
- 12 Volt DC Oil Pump

P28

P28
P28



Oil Transfer Tank Systems

- IBC Oil Tank Station
- Uni Tank Oil Station

P29

P29
P29



Diaphragm Pumps

- Diaphragm Pumps
- Diaphragm Pump Kit
- Rotary Pump

P32-33

P32
P33
P33



Hose Reels

- Oxy-Acetylene Hose Reel
- Hot Wash Hose Reel
- Oil Hose Reels
- Hose Reel Pivot Brackets

P34-37

P34
P34
P35-37
P37



Oil Control Guns / Meters

- Digital Oil Control Guns
- Mechanical Oil Control Guns
- Manual Oil Control Guns
- Oil Meters

P38-42

P38-39
P40
P41
P42



Drip Tray, Oil Bar & Accessories

- Oil Pump Accessories
- Nozzle Drip Tray
- Oil Bar
- Oil Hose & Identification Covers
- Oil Bar Accessories
- Oil Control Gun Accessories

P30-31, 43-44

P30-31
P43
P43
P43
P44
P44





Air Operated Oil Transfer



Equipped with Lubricator

1:1 Air Operated Oil Pump

- Suitable for oil bars, 205 litre drums and bulk tanks
- Air operated for integration into transfer system
- Smart design with fewer parts for less pump wear offering long life
- Differential air motor ensures smooth pumping
- Typical fluids handled include motor oil, synthetic oil, hydraulic oil, automatic transmission fluid and coolant
- Suitable for oil up to SAE 120
- Supplied with adjustable 2" bung adaptor
- Not suitable for pumping distances of more than 6 metres when reasonable volume is required



DIT11701001



DIT11701003



DIT11701004



DIT11701006

MODEL	DIT11701001	DIT11701003	DIT11701004	DIT11701006
Drum Application	Stub	205 litre drum	Stub	205 litre drum
Pressure ratio	1:1	1:1	1:1	1:1
Working pressure	70-115psi	70-115psi	70-115psi	70-115psi
Air consumption	@115psi 3.6 CFM	@115psi 3.6 CFM	@115psi 4.7 CFM	@115psi 4.7 CFM
Max flow rate (per min)	18 litres	18 litres	32 litres	32 litres
Suction tube diameter	42mm	42mm	42mm	42mm
Suction tube length	270mm	940mm	270mm	940mm
Air inlet connection	¼" BSP Female	¼" BSP Female	¼" BSP Female	¼" BSP Female
Oil outlet connection	½" BSP Male	½" BSP Male	¾" BSP Male	¾" BSP Male



Air Operated Oil Transfer



Equipped with Lubricator

3:1 Air Operated Oil Pump

- Suitable for pumping through medium sized hose reel systems when one or two hose reels are required
- Air operated for integration into transfer system
- Long pumping life, easy to operate and maintain
- Smart design with fewer parts for less pump wear
- Differential air motor ensures smooth pumping
- Typical fluids handled include motor oil, synthetic oil, hydraulic oil, gear oil, automatic transmission fluid and coolant
- Suitable for oil up to SAE 150
- Supplied with adjustable 2" bung adaptor



Optional (Recommended)
Pressure relief valve
(DIT119572501) page 30



MODEL	DIT11701031	DIT11701033	DIT11701034	DIT11701036
Drum application	Stub	205 Litre drum	Stub	205 litre drum
Pressure ratio	3:1	3:1	3:1	3:1
Working pressure	70-115psi	70-115psi	70-115psi	70-115psi
Air consumption	@ 115psi 3.9 CFM	@ 115psi 3.9 CFM	@ 115psi 5.0 CFM	@ 115psi 5.0 CFM
Max flow rate (per min)	12 litres	12 litres	28 litres	28 litres
Suction tube diameter	42mm	42mm	42mm	42mm
Suction tube length	270mm	940mm	270mm	940mm
Air inlet connection	¼" BSP Female	¼" BSP Female	¼" BSP Female	¼" BSP Female
Oil outlet connection	½" BSP Male	½" BSP Male	¾" BSP Male	¾" BSP Male



Air Operated Oil Transfer

5:1 Air Operated Oil Pump



Equipped with Lubricator



Optional (Recommended)
Pressure relief valve
(DIT119572501) page 30

- Suitable for pumping through medium to large sized hose reel systems when 2 or more oil dispensing nozzles are required
- Air operated for integration into transfer system
- Long pumping life, easy to operate and maintain
- Smart design with fewer parts for less pump wear
- Differential air motor ensures smooth pumping
- Typical fluids handled include motor oil, synthetic oil, hydraulic oil, gear oil, automatic transmission fluid and coolant
- Suitable for oil up to SAE 240
- Supplied with adjustable 2" bung adaptor



MODEL	DIT11701051	DIT11701053	DIT11701054	DIT11701056
Drum application	Stub	205 Litre drum	Stub	205 litre drum
Pressure ratio	5:1	5:1	5:1	5:1
Working pressure	70-115psi	70-115psi	70-115psi	70-115psi
Air consumption	@115psi 4.5 CFM	@115psi 4.5 CFM	@115psi 11.3 CFM	@115psi 11.3 CFM
Max flow rate (per min)	14 litres	14 litres	28 litres	28 litres
Suction tube diameter	42mm	42mm	42mm	42mm
Suction tube length	270mm	940mm	270mm	940mm
Air inlet connection	¼" BSP Female	¼" BSP Female	¼" BSP Female	¼" BSP Female
Oil outlet connection	½" BSP Male	½" BSP Male	¾" BSP Male	¾" BSP Male



Air Operated Oil Transfer

5:1 High Volume Air Operated Oil Pump



- Suitable for oil transfer in high volume and long distance applications such as truck shop service fleet facilities and in-plant applications
- Corrosion resistant design utilizes liquid salt nitriding, nickel plating, stainless steel, aluminium and chrome on key components for longer life
- Few moving parts in the air motor assembly means less downtime and low repair cost
- Large air porting design provides efficient use of compressed air supply for continuous pump operation without icing
- Typical fluids handled include motor oil, synthetic oil, hydraulic oil, gear oil, automatic transmission fluid and coolant
- Suitable for oil up to SAE 240
- Supplied with adjustable 2" bung adaptor

See 5:1 High Volume Kit pg.27
MODEL: DITI10105334



DITI17940022

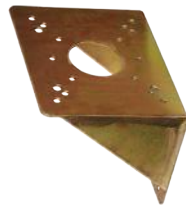

DITI17910010



DITI19810401



DITI17930070



DITI17130501

• Optional suction tubes



DITIET20670

670mm



DITIET20920

920mm

MODEL (High Volume Accessories)	DITI10105334
Wall bracket	DITI17910010
Suction hose adapter	DITI17940022
Pump adapter	DITI17940021
Rigid suction tube	DITI1792001
Suction hose	DITIB20006
Worm gear	DITIB10007
Bung adaptor	DITI19810401
Foot Valve	DITIFV0002
Filter	DITI17930070
Drip tray	DITI10001

MODEL	DITI17130501
Application	Stub
Pressure ratio	5:1
Working pressure	70-180psi
Air consumption	@115psi 21.6 CFM
Max flow rate (per min)	40 litres
Suction tube diameter	54mm
Suction tube length	270mm
Air inlet connection	¼" BSP Female
Oil outlet connection	¾" BSP Female
DITIET20670 - Optional	670mm suction tube to suit 205 litre drums
DITIET20920 - Optional	920mm suction tube to suit 1000 litre IBC tanks



Air Operated Oil Transfer

1:1 Air Operated Oil Pump Bar

- A faster more efficient alternative for transferring oils from 205 litre drums
- Ideal for filling oil jugs or bottles
- Foot valve and strainer fitted to suction pipe
- Fitted with regulator, gauge, ½" oil tap and on/off air cock
- CK602 - Optional drip tray to support oil jug (DIT118980011)
- CK602 - Can be optioned as wall mounted type, contact STM for details



CK602



CK603

MODEL	CK602	CK603
Drum application	205 Litre drum	205 Litre drum
Pressure ratio	1:1	1:1
Working pressure	20-115psi	20-115psi
Air consumption	@115psi 3.6 CFM	@115psi
Max flow rate (per min)	18 litres	35 litres
Suction tube diameter	42mm	49mm
Suction tube length	940mm	940mm
Air inlet connection	½" BSP Female	½" BSP Female
Oil outlet connection	½" BSP Male	½" BSP Male
KIT BREAKDOWN		
1:1 Air operated oil pump	DIT11701003	DR70011940
Spigot	DIT1602S	DIT1602S
Regulator gauge	DIT1AR2000	DIT1AR2000



Air Operated Oil Transfer



Wall Mounted Transfer Kit

- Wall mounted kit
- Suitable for dispensing oil to mobile installations with optional hose and nozzle or directly through hose reels
- Supplied with all required fittings and accessories for connection of pump to the air and from tank to pump
- Rigid suction tube with 2 metre hose assembly

Optional:

- To make suction tube longer use DITIET10200 or DITI10500 in conjunction with DITIET10001 and DITIET10003
- If longer suction hose is required then will need DITIWB10004, DITIWB10002, hose clips YS295-040 and hose DITIPVC25



Equipped with Lubricator



MODEL	DITI1700111	DITI1700211	DITI1700311
Drum application	Wall mounted	Wall mounted	Wall mounted
Pressure ratio	1:1	3:1	5:1
Working pressure	20-115psi	20-115psi	20-115psi
Air consumption	@115psi 3.6 CFM	@115psi 3.9 CFM	@115psi 4.5 CFM
Max flow rate (per min)	18 litres	12 litres	14 litres
Suction tube diameter	42mm	42mm	42mm
Suction tube length	95mm	270mm	270mm
Air inlet connection	¼" BSP Female	¼" BSP Female	¼" BSP Female
Oil outlet connection	½" BSP Male	½" BSP Male	½" BSP Male
Maximum SAE viscosity	SAE 120	SAE 150	SAE 240
KIT BREAKDOWN			
Air operated oil pump	DITI1701001	DITI1701031	DITI1701051
Lubricator	DITIBL2000	DITIBL2000	DITIBL2000
Suction hose	DITIPVC1000MF2	DITIPVC1000MF2	DITIPVC1000MF2
Wall bracket	DITIWB10001	DITIWB10001	DITIWB10001
940mm suction tube	DITIWB10005	DITIWB10005	DITIWB10005
Bung adaptor	DITIBG00001	DITIBG00001	DITIBG00001
1" x 1" male nipple	DBN25	DBN25	DBN25
1" x 1" elbow	DBE2525MF	DBE2525MF	DBE2525MF
Top elbow nipple connector	DITIWB10001	DITIWB10001	DITIWB10001
Foot valve	DITIFV00001	DITIFV00001	DITIFV00001
Foot strainer	DITIFR00001	DITIFR00001	DITIFR00001



Air Operated Oil Transfer

1:1 Air Operated Oil Pump Kit

MODEL DITI1701003KIT



Equipped with
Lubricator / Regulator



MODEL DITIDM10002
Meter option available

- Complete kit for oil transfer from 205 litres drums
- Typical fluids handled include motor oil, synthetic oil, hydraulic oil, automatic transmission fluid and coolant
- Equipped with delivery hose, oil control gun and air regulator/filter/lubricator
- Adjustable 2" bung adaptor



MODEL	DITIDM1002
Flow rate	1-35 LPM
Inlet/outlet Connection	½" BSP
Maximum Pressure	725psi
Precision	±0.5%

MODEL	DITI1701003KIT
Drum application	205 litre drum
Pressure ratio	1:1
Working pressure	20-115psi
Air consumption	@115psi 3.6 CFM
Max flow rate (per min)	18 litres
Suction tube diameter	42mm
Suction tube length	940mm
Air inlet connection	¼" BSP Female
Oil outlet connection	½" BSP Male
Maximum SAE viscosity	SAE 120
KIT BREAKDOWN	
1:1 Air operated oil pump	DITI1701003
Air filter/regulator/lubricator	DITIA2000
Manual oil nozzle - rigid spout	DITI1782801
4 Metre oil hose	DITI1763413



Portable Oil Transfer Kits



Equipped with Lubricator

3:1 Air Operated Portable Oil Transfer Kit

- Portable unit for 20, 60 & 205 litre drums
- Suitable for dispensing oil at medium viscosity up to SAE 150 for mobile applications
- Drum trolley with heavy duty wheels and castors ensures high mobility and efficiency
- Standard model composed of 3:1 pump, trolley, digital oil meter with nozzle and 4 metres of connection hose
- Supplied with adjustable 2" bung adaptor



DIT11700222



DIT11700232



DIT11700233

MODEL	DIT11700222	DIT11700232	DIT11700233
Drum application	20 & 60 litre drums	205 litre drums	205 litre drums
Pressure ratio	3:1	3:1	3:1
KIT BREAKDOWN			
3:1 Air operated oil pump	DIT11701033	DIT11701033	DIT11701033
Lubricator	DITIBL2000	DITIBL2000	DITIBL2000
Digital oil nozzle	DIT11781501	DIT11781501	DIT11781501
Drum trolley	DIT11708001	DIT11708002	DIT11708003
Hose assembly	DIT11763413	DIT11763413	DIT11763413
Hose reel	-	-	DITIM860154



Portable Oil Transfer Kits



Equipped with Lubricator

5:1 Air Operated Portable Oil Transfer Kit

- Portable unit for 20, 60 & 205 litre drums
- Suitable for dispensing oil at high viscosity up to SAE 240 for mobile applications
- Drum trolley with heavy duty wheels and castors ensures high mobility and efficiency
- Standard model composed of 5:1 pump, trolley, digital oil meter with nozzle and 4 metres of connection hose
- Supplied with adjustable 2" bung adaptor



DITI1700322



DITI1700333



DITI1700332



DITI10105334

OIL TRANSFER EQUIPMENT

MODEL	DITI1700322	DITI1700332	DITI1700333	DITI10105334
Drum application	20 - 60 litre drums	205 litre drums	205 litre drums	205 litre drum
Pressure ratio	5:1	5:1	5:1	5:1 (High Volume)
KIT BREAKDOWN				
5:1 Air operated oil pump	DITI1701053	DITI1701053	DITI1701053	DITI17130501
Lubricator	DITIBL2000	DITIBL2000	DITIBL2000	DITIBL2000
Digital oil nozzle	DITI1781501	DITI1781501	DITI1781501	DITI18124505
Drum trolley	DITI1708001	DITI1708002	DITI1708003	DITI1708003
Hose assembly	DITI1763413	DITI1763413	DITI1763413	DITI17636050
Hose reel	-	-	DITIM860154	DITIHRM808106
670mm Suction tube	-	-	-	DITIET20670



Electric Oil Pump Motors

240 Volt Gear Oil Pump

- For oils and lubricants
- Die-cast aluminium body, sintered steel gears
- IP55 protection class motor
- Self priming pump
- By-pass integrated into the pump body, relief valve device
- 2 Metre suction height



DITI17320140 / DITI17320091



DITI17320400

MODEL	DITI17320140	DITI17320091	DITI17320400
Max flow rate (per min)	14 litres	9 litres	40 litres
Working pressure	175psi / 12bar	360psi / 25bar	145psi / 10bar
Inlet/outlet	1" BSP	1" BSP	1" BSP
Voltage	240V	240V	240V
Power	750 watt	750 watt	1100 watt

12 Volt DC Oil Pump

MODEL DITI17520100

- Flow rate of 10 litres per minute
- Viscosity up to 500Cst
- Sintered steel gears, bypass valve incorporated in pump body
- IP55 protection class motor
- 2 Metre suction height
- 3/4" BSP inlet/outlet



Pneumatic Oil Dispenser

MODEL DITIPOD065

- Pneumatic oil dispenser equipped with level gauge and delivery gun with flexible end
- Suitable for filling or topping up
- Filled with oil (to 80% capacity) and pressurised with air at 7-8 bar, they work autonomously anywhere and don't require continuous air connection
- Comes with anti splash funnel

Tank capacity	65 litres
Maximum working pressure	145psi
Gun length with flexible hose	478mm
Hose length	2 metres
Air inlet connection	1/4" BSP female



Oil Tank Transfer Systems

IBC Oil Tank Station

MODEL DOTIBCKIT2

- Suitable for IBC 1000 litre oil storage unit
- Comprises of 3:1 air operated oil pump, hose reel, digital oil nozzle and drip tray
- Can be optioned with other various items than below to suit your needs



• IBC tank not included

MODEL	DITIIBCKIT
Tank capacity	1000 litre
KIT BREAKDOWN	
3:1 Air operated oil pump	DITI1701033
Digital oil nozzle	DITI1781501
Hose Reel - 15m x ½" hose	DITIM860154
Drip tray	DITIDT10001
Top bracket	DITI19808102
Side bracket	DITI19808101
Hose assembly	DITI1763405
Top extension connection	DITIET10001
Extension tube	DITIET10200
Extension foot connection	DITIET10003

Uni Tank Oil Station

MODEL DOTUNIKIT

- Comprises of 3:1 air operated oil pump, double skin oil storage tank, hose reel, digital oil nozzle and drip tray
- HDPE internal with zinc coated sheet external
- Visual leakage indicator & filling level indicator
- Can be optioned with 750 or 1500 litre tank or other various items to suit your needs



MODEL	DOTIBCKIT
Tank capacity	1000 litre
Dimensions	1280mm x 770mm x 1420mm
KIT BREAKDOWN	
3:1 Air operated oil pump	DITI1701033
Digital oil nozzle	DITI1781501
1000 litre tank	DOT7380
Hose Reel - 15m x ½" hose	DITIM860154
Drip tray	DITIDT10001
Universal bracket	DUB001
Hose assembly	DITI1763405
Top extension connection	DITIET10001
Extension tube	DITIET10200
Extension foot connection	DITIET10003



Oil Transfer Accessories



Pressure Relief Valve

MODEL DIT19572501

- Pressure range 70-730psi (5 to 50 bar)
- ½" BSP
- Protects pipe work, fittings and outlet guns from high pressures caused by incorrect air pressure or thermal expansion
- Offers in-line relief and can be fitted directly onto the outlet of pump
- Recommended for applications using oil pipe distribution networks or when using 3:1 or higher air operated pumps
- Also Available: Pressure Relief Valve 3/4 Outlet - DIT19572511

Extension Tube & Accessories

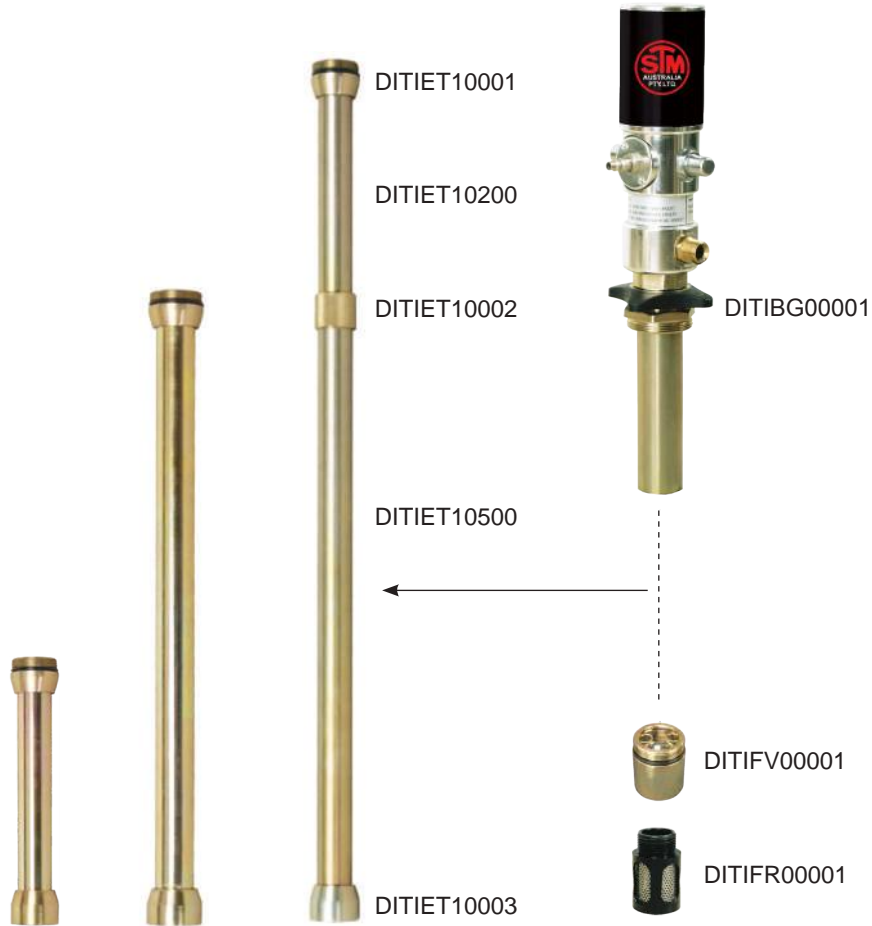

MODEL	DESCRIPTION
DITIET10001	Top extension connection - M40 x 1.5 thread
DITIET10200	Extension tube - 200mm
DITIET10002	Extension sleeve adaptor
DITIET10500	Extension tube - 500mm
DITIET10003	Extension foot connection - female threads
DITIBG00001	Bung adaptor
DITIFV00001	Foot valve
DITIFR00001	Foot strainer



Oil Transfer Accessories



MODEL	DESCRIPTION
DITIWB10001	<ul style="list-style-type: none"> Pump wall bracket to suit Ø42mm tube
DITIWB10002	<ul style="list-style-type: none"> Pump suction barb 1" BSP x Ø31mm barb
DITIWB10004	<ul style="list-style-type: none"> Suction tube hose barb M40 x 1.5 x Ø31mm barb, mates with model no. DITIWB10005
DITIWB10005	<ul style="list-style-type: none"> Steel suction tube Ø42mm x 940mm long with M40 x 1.5 female threads
DITIWB10001	<ul style="list-style-type: none"> Top elbow/nipple connector M40 x 1.5 Female x 1" BSP Female Mates with suction tube model no. DITIWB10005
DBN25	<ul style="list-style-type: none"> 1" x 1" Male nipple
DR70011940AD	<ul style="list-style-type: none"> Pump suction extension adaptor Suitable for DR70011940 oil pump O.D - M26 x 1.5 I.D - M30 x 1
DITIPVC1000MF2	<ul style="list-style-type: none"> 2 metre suction hose kit 1" Male x 1" Female, reinforced transparent PVC Where distance from suction tube and pump is up to 2 metres BSP threads
DITIPVC19	<ul style="list-style-type: none"> Reinforced transparent PVC hose Ø19mm I.D.
DITIPVC25	<ul style="list-style-type: none"> Reinforced transparent PVC hose Ø25mm I.D.
DITIPVC32	<ul style="list-style-type: none"> Reinforced transparent PVC hose Ø32mm I.D. Where application requires longer hose between suction tube and pump
YS295-040	<ul style="list-style-type: none"> Hose clip 30 to 40mm O.D. hose



Diaphragm Pumps

Air Operated Double Diaphragm Pump

- Air operated diaphragm pump to transfer high volumes of fluids from drums or tanks
- Suitable for oil, diesel, coolant, ATF, waste oil and water
- Heavy duty construction with ground capability to eliminate static discharge
- Both metal & plastic bodies are available
- Maximum diameter solid: 1/8"
- A variety of elastomer options including Buna-N (Nitrile), Viton, EPDM & PTFE are available to meet abrasion, temperature and chemical compatibility concerns
- Viton, EPDM & PTFE are available on request
- DIT117150600 & DIT117150601 - 3/4" inlet/outlet, also supplied with 1/2" reducer



DIT117151200



DIT117151201



DQBY40AAB, DQBY 50AAB



DIT117150600N



DIT117150601V



DQBY15PPTF, DQBY 25PPTF

MODEL	Material	Max flow rate	Seals	Max pressure	Inlet/Outlet	Air Inlet
DQBY15PPTF	Polypropylene	20 LPM	Teflon	100psi	1/2"	1/4"
DIT117150600N	Aluminium	45 / 60 LPM	Buna	115psi	1/2" / 3/4"	1/4"
DIT117150601V	Polypropylene	45 / 60 LPM	Viton	115psi	1/2" / 3/4"	1/4"
DIT117151200	Aluminium	90 LPM	Buna	115psi	1"	1/4"
DIT117151201	Polypropylene	90 LPM	Buna	115psi	1"	1/4"
DQBY25PPTF	Polypropylene	40 LPM	Teflon	100psi	1"	1/4"
DQBY40AAB	Aluminium	135 LPM	Buna	100psi	1 1/2"	1/4"
DQBY50AAB	Aluminium	200 LPM	Buna	100psi	2"	1/4"



Diaphragm Pumps

Air Operated Diaphragm Pump Kit

MODEL DQBYKIT

- Air operated diaphragm pump kit to transfer high volumes of fluids from drums or tanks
- Ability to quickly and easily move pump from one drum to another as it sits in a 2" bung hole and doesn't need to be screwed in
- Suitable for oil, diesel, coolant, ATF, waste oil and water
- High flow rate of up to 90 litres per minute
- Kit composed of 1" diaphragm pump, manual nozzle, 4 metres of connection hose, steel suction tube, camlock fittings for easy dismantling & storage and air regulator



KIT BREAKDOWN	MODEL
Diaphragm pump	DIT117151200
Manual nozzle	DKSK9151A
Hose assembly (4 metres)	DKSK19138401
PVC suction tube	CB285-6
Elbow	YS60725-16
Air regulator	DIT1AR2000
Coupling (QTY: 2)	STPC25-D-AL
Dust plug (QTY: 2)	STPC25-DP-AL
Dust cap (QTY: 2)	STPC25-DC-AL
Adaptor (QTY: 2)	STPC25-F-AL

Air Operated Rotary Pump

MODEL DO31221

- Air operated rotary pump
- Aluminium motor, stainless steel casing, viton gaskets, and PTFE gears
- ¼" ball valve included
- Suction head up to 2 metres
- Suitable for a variety of chemicals (check with STM for chemical compatibility)



Application	Chemicals
Working pressure	25 - 100psi
Max flow rate per minute	10 litres
Air inlet	¼" BSP Female
Inlet/outlet	½"



Hose Reels

Oxy-Acetylene Hose Reel

MODEL DB320D150P300

- Heavy duty steel construction with corrosion resistant powder coating
- Full flow swivel joint and swivel body are made from drop forging brass
- Double 'O' ring sealed design prevents leakage
- Swivel body and inlet are both permanently identified with machined grooves on the acetylene side to assure proper installation
- Multiple mounting positions for flexibility
- Hose conforms to Australian standards AS1335-1995



Application	Oxy-Acetylene
Inlet	3/8" x 18 UNF, left & right threads
Maximum pressure	300psi
Hose I.D	5mm
Hose length	15 metres

Heavy Duty Hot Wash Hose Reel

MODEL DIRS4153

- Spring driven double arm hose reel
- Heavy duty construction for long life in industrial and automotive applications
- High quality impact resistant ABS drum
- Arm and bracket in 304 stainless steel
- Wall, ceiling or floor mounted



Application	Hot Water
Inlet/Outlet (fitting)	3/8"
Maximum pressure	2900psi
Hose I.D	3/4"
Hose length	15 metres



Hose Reels

ABS Drum Hose Reel



- Spring driven double arm hose reel
- Designed to transfer oil, grease, water and air
- High quality impact resistant ABS drum
- Heavy duty carbon steel arm and bracket in corrosion resistant powder coating
- Comes with 1.5 metre inlet hose
- Wall, ceiling or floor mounted

MODEL	DIRA3152	DIRA1153	DIRA2154
Application	Grease	Air & water	Oil
Inlet/Outlet (fitting)	¼"	¾"	½"
Maximum pressure	5000psi	300psi	2000psi
Hose I.D	¼"	¾"	½"
Hose length	15 metres	15 metres	15 metres

Oil & Fuel Hose Reel



- Designed for industrial application where longer hose is required
- Constructed with heavy-duty powder coated steel
- Easy to install and maintain
- Conveniently keeps hose organized for a more efficient work area
- Transfer media: fuel & oil

MODEL	DITIHRM808106
Application	Oil, diesel & petrol
Inlet/Outlet (fitting)	¾"
Maximum pressure	1250psi
Hose I.D	¾"
Hose length	10 metres

Large Capacity Hose Reel



- Double arm hose reel
- Large reeling capacity
- Heavy duty steel construction with corrosion resistant powder coating
- Spring fully enclosed and lubricated
- Four-direction non-snag hose rollers reduce hose wear
- Guide arm adjustable, floor mount
- Multi-position ratchet lock and easy tension adjustment

MODEL	DITIM880304	DITIM880206	DITIM880158
Application	Oil, water & diesel	Oil, water & diesel	Oil, water & diesel
Inlet/Outlet (fitting)	½"	¾"	1"
Maximum pressure	2000psi	1250psi	1000psi
Hose I.D	½"	¾"	1"
Hose length	30 metres	20 metres	15 metres



Hose Reels

Heavy Duty Enclosed Hose Reel

- Heavy duty construction
- Designed to transfer oil, grease, water and air
- Compact size and easy installation
- Spring tension easily adjustable from the outside
- Four direction non-snap rollers reduce hose wear abrasion
- Mounting bracket can be repositioned for varied application



MODEL	DITI29509152R2	DITI29507153R	DITI29508154R1
Application	Grease	Air & water	Oil
Inlet/Outlet (fitting)	¼"	¾"	½"
Maximum pressure	5000psi	300psi	2000psi
Hose I.D	¼"	¾"	½"
Hose length	15 metres	15 metres	15 metres

Heavy Duty Enclosed Oil Hose Reel

MODEL DIRC2094

- Heavy duty construction with steel spring driven hose reel
- Carbon steel drum, arm and bracket in corrosion resistant powder coating for long lasting
- Suitable for the industrial and automotive environments
- Compact in size and easy installation
- Can be mounted to the ceiling, wall or floor
- 2000psi max working pressure
- 9 meter hose length
- 2 meter leading hose length



MODEL	DIRC2094
Application	Oil
Inlet/Outlet (fitting)	½"
Maximum pressure	2000psi
Hose I.D	½" BSP
Hose length	9 metres



Hose Reels

Heavy Duty Hose Reel

- Double arm steel hose reel
- Simple construction for easy installation
- Spring locates in the middle to ensure stability of the reel
- Four-direction non-sag hose rollers reduce hose wear
- Adjustable arm guide (wall, floor, ceiling and pit)
- Elegant appearance
- Special swivel joint for easy maintenance and repair
- Ball bearing swivel joint structure, largely reducing the friction between swivel spool and swivel body



MODEL	DITIH860152	DITIH860153	DITIL860153	DITIM860154
Application	Grease & oil	Grease	Air & water	Oil & water
Inlet/Outlet (fitting)	¼"	¾"	¾"	½"
Maximum pressure	5000psi	4000psi	300psi	2000psi
Hose I.D	¼"	¾"	¾"	½"
Hose length	15 metres	15 metres	15 metres	15 metres

Hose Reel Pivot Bracket

- Wall bracket for mounting hose reels
- 140° wall bracket for mounting hose reels
- For 860, ABS & Oxy-Acetylene hose reels
- Steel construction



DITIBR0106

MODEL	DITIBR0106
Application	860 Series
Suitable for the following reels	DITIH860152
	DITIH860153
	DITIL860153
	DITIM860154



Digital Oil Control Guns

Digital Oil Control Gun

- Suitable for motor oil, gear oil, automatic transmission fluid (ATF)
- Durable and lightweight
- Measures in litre, gallon, pint and quart
- 5 digit easy to read LCD display, with low battery indicator
- Resettable for daily, weekly and lifetime dispense reports
- Equipped with swivel & strainer



DITI1781501

DITI1781502

DITI1781503

MODEL	DITI1781501	DITI1781502	DITI1781503
Flow rate	1-35 LPM	1-35 LPM	1-35 LPM
Inlet connection	½" BSP	½" BSP	½" BSP
Maximum pressure	750psi	750psi	750psi
Precision	±0.5%	±0.5%	±0.5%
Spout	Rigid, manual tip	Flexible, automatic tip	Flexible, manual tip
Meter	DITIDM10002	DITIDM10002	DITIDM10002

High Volume Digital Oil Control Gun

- High flow up to 45 litres per minute
- Durable and light weight construction
- Suitable for motor oil, gear oil, automatic transmission fluid (ATF)
- Locking trigger for hands free operation
- Equipped with swivel & strainer



DITI18114505

DITI18124505

MODEL	DITI18114505	DITI18124505
Flow rate	1-45 LPM	1-45 LPM
Inlet connection	¾" BSP	¾" BSP
Maximum pressure	1500psi	1500psi
Precision	-	±0.5%
Spout	Rigid, automatic tip	Rigid, manual tip
Meter	-	DITI15230451



Digital Oil Control Guns

Digital Preset Oil Control Gun

MODEL DITIPMG35A

- Preset function means nozzle automatically closes valve and stops dispensing when required amount has passed through
- Five presettable totals which can be changed for frequency required volumes
- Ergonomic plastic shell
- Measures in litres, gallons, pints and quarts
- Easy read out digital display
- Equipped with swivel & strainer



Shockproof Cover
Rubber & trigger protection prevents accidental operation

MODEL	DITIPMG35A
Flow rate	1-35 LPM
Inlet connection	½" BSP
Maximum pressure	1000psi
Precision	±0.5%
Spout	Flexible, automatic tip

Extra High Volume Digital Control Gun

- High flow up to 60 litres per litre
- Suitable for oil and diesel
- Durable and lightweight
- Measures in litres, gallons, pints and quarts (DIT18126005)
- 5 digit easy to read LCD display, with low battery indicator (DIT18126005)



DIT18116005



DIT18126005

MODEL	DIT18116005	DIT18126005
Flow rate	1-60 LPM	1-60 LPM
Inlet connection	¾" BSP	¾" BSP
Maximum pressure	1000psi	750psi
Precision	-	±0.5%
Spout	Rigid, manual tip	Rigid, manual tip
Meter	-	DIT15210601



Mechanical Oil Control Gun

Mechanical Preset Oil Nozzle



DO15870, DO15871

- Durable design made for the industrial environment & vehicle or machine service applications for use indoors or outdoors
- Heavy-duty metal construction
- Can be used without preset facility
- Measures in litre
- High impact resistant nylon shroud
- Equipped with swivel & strainer

MODEL	DO15871	DO15870
Flow rate	1-35LPM	1-35LPM
Preset range	1-16 LPM	1-60LPM
Inlet connection	½" BSP	½" BSP
Maximum pressure	1000psi	1000psi
Precision	±0.65%	±0.65%
Spout	Flexible, manual tip	Flexible, manual tip

60 YEARS OF SUPPLYING INDUSTRIAL INDUSTRY

- GREASE GUNS
- DIAPHRAGM PUMPS
- OIL TRANSFER
- HAND PUMPS

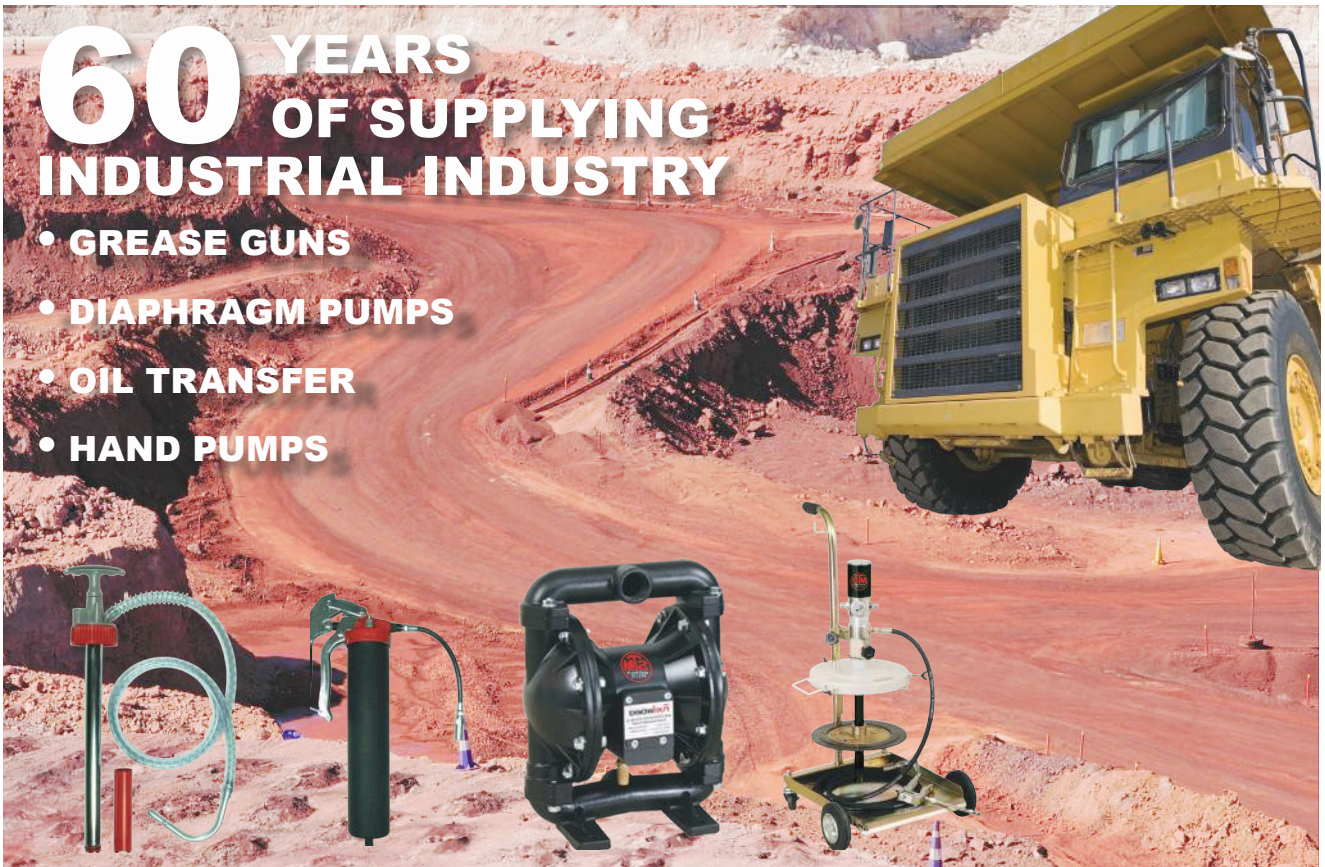



Manual Oil Control Guns

Manual Oil Control Gun

- Suitable for motor oil, gear oil, automatic transmission fluid (ATF)
- Durable and light weight
- Equipped with swivel & strainer



DITI1782801



DITI1782802

MODEL	DITI1782801	DITI1782802
Flow rate	1-35 LPM	1-35 LPM
Inlet connection	½" BSP	½" BSP
Maximum pressure	750psi	750psi
Spout	Rigid, manual tip	Flexible, automatic tip

Heavy Duty Oil Control Gun

- Durable design made for the industrial environment
- Suitable for motor oil, gear oil, automatic transmission fluid (ATF)
- Locking trigger for hands free operation
- Durable and light weight
- Equipped with swivel & strainer



DITI18113515



DITI18113516

MODEL	DITI18113515	DITI18113516
Flow rate	1-35 LPM	1-35 LPM
Inlet connection	½" BSP	½" BSP
Maximum pressure	1500psi	1500psi
Spout	Rigid, manual tip	Flexible, automatic tip



Oil Meters

Digital Oil Meter

- Suitable for oil (DITI15210603 - Also suitable for diesel)
- Measures in litre, gallon, pint and quart
- 5 digit easy to read LCD display, with low battery indicator
- Rubber protection, shatter proof
- DITI15230451 - Ideal for harsh environment



DITIDM10002



DITI15230451



DITI15210601/DITI15210603

MODEL	DITIDM10002	DITI15230451	DITI15210601	DITI15210603
Flow rate	1-35 LPM	1-45 LPM	1-60 LPM	1-60 LPM
Inlet/outlet connection	½" BSP	½" BSP	¾" BSP	1" BSP
Maximum pressure	725psi	1500psi	725psi	725psi
Precision	±0.5%	±0.5%	±0.5%	±0.5%

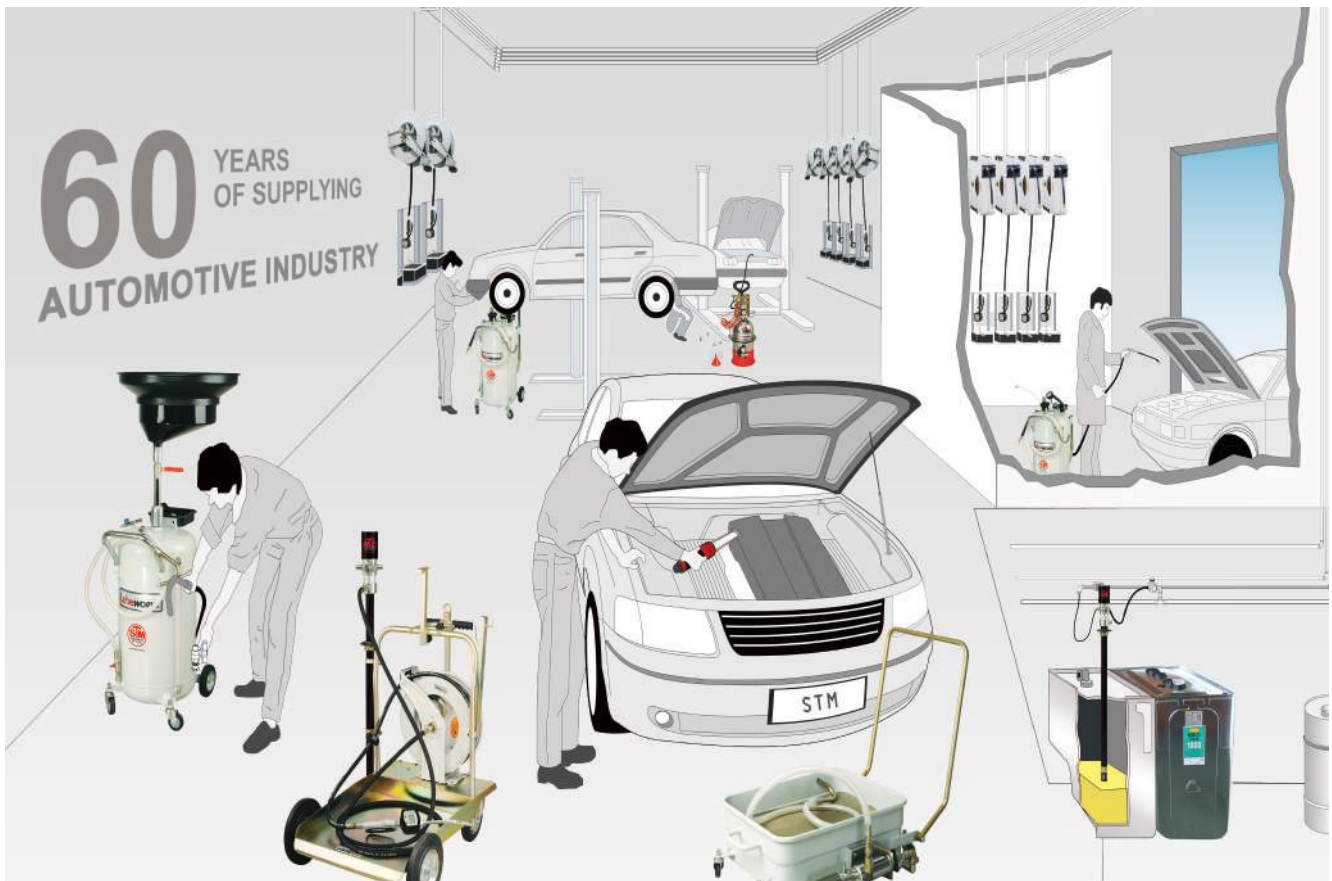



Nozzle Drip Tray

MODEL DITIDT10002

- Collect oil drops from nozzles for a clean and safe workshop
- Metal construction with powder coating paint
- Removable drip tray for easy emptying
- Large integral bracket for easy loading and unloading of hose and nozzle



• Meters not included

Oil Bar

MODEL DITI18711001

- Ideal system for fast dispensing of oil lubricants
- Supplied with one oil tap (when adding additional taps you will require MODEL DITI18711001E)
- Removable drip tray for easy emptying
- ½" BSP inlet
- Dimensions: 53cm (w) x 63cm (h) x 40cm (d)
- Suitable for up to 3 oil taps & 3 meters

Oil Hose Assemblies

- Oil hose SAE 100 R1
- Working pressure 2000psi
- Male thread fixed / female thread swivel



MODEL	Length	Inlet/Outlet	MODEL	Length	Inlet/Outlet
DITI1763405	1.5 metres	½" BSP	DITI17636050	1.5 metres	¾" BSP
DITI1763407	2 metres	½" BSP	DITI17636070	2 metres	¾" BSP
DITI1763413	4 metres	½" BSP	DITI17636130	4 metres	¾" BSP
DITI1763433	10 metres	½" BSP	DITI17634330	10 metres	¾" BSP
DITI1763450	15 metres	½" BSP	DITI17636500	15 metres	¾" BSP



Oil Identification Cover

- Easily identify transfer liquids with different colour control gun covers
- Connect between oil control valve and ½" hose
- Five colour options: red, blue, black, green, yellow
- Made of Thermoplastic rubbers (TPE)



MODEL	DITI198104BK	DITI198104BU	DITI198104GR	DITI198104RE	DITI198104YE
Colour	Black	Blue	Green	Red	Brown



MODEL	DESCRIPTION
DUB001	<ul style="list-style-type: none"> • Mounting bracket suitable for IBC and Uni tanks • For assembly of hose reel and drip tray
DITI19808101 DITI19808102	<ul style="list-style-type: none"> • Adjustable mounting brackets suitable for IBC and Uni tanks • For assembly of hose reel and drip tray • DITI19808101 (Side bracket) • DITI19808102 (IBC Top bracket)
DITI18711001E	<ul style="list-style-type: none"> - Oil bar elbow extension - For connection between hose, tap or meter
DITI18940011	<ul style="list-style-type: none"> - Oil tap - Connect to oil bar (DITI18711001) or directly to oil pump - ½" BSP Male
DITI18940131	<ul style="list-style-type: none"> - Oil transfer tap kit - Superior design - Can be fitted directly to oil transfer pump - ½" BSP Female
DA602S	<ul style="list-style-type: none"> • CK602 spigot - Can be fitted directly to oil transfer pump • ½" BSP Female
DITI18980011	<ul style="list-style-type: none"> - Drip tray for oil transfer pump - Suitable for pumps with suction tube diameter - 43mm
DITIMH10001	<ul style="list-style-type: none"> • Rigid spout, ½" BSP Male
DITIMH10002	<ul style="list-style-type: none"> • Flexible hose spout, ½" BSP Male • Includes tip (DITIMT10002)
DITIMT10001	<ul style="list-style-type: none"> • Manual anti drip tip, ¼" BSP Female • Suitable for rigid & flexible spout
DITIMT10002	<ul style="list-style-type: none"> • Auto anti drip tip, ¼" BSP Female • Suitable for rigid & flexible spout
DITICR2	<ul style="list-style-type: none"> • Battery • For oil meters DITI1781501, DITI1781502, and DM10002

FUEL TRANSFER EQUIPMENT



FUEL TRANSFER
EQUIPMENT



Table of Contents

Fuel Transfer Equipment

P47-60

Fuel Transfer Pump Motors & Kits

- 12, 24 & 240 Volt Diesel Pump Kits
- 12 & 24 Volt Diesel Pump Carry Kit
- 12, 24 & 240 Volt Pump Motors
- 12, 24 & 240 Volt Petrol Pump Kits
- 240 Volt Diesel Pump Kit
- 240 Volt Diesel Bowser Kits

P47-50

P47
P48
P48
P49
P49-50
P50



Tank Systems

- Diesel Tank Transfer Kit
- Mobile Diesel Transfer Tanks

P51-52

P51
P52



Hose Reels

- Diesel Transfer Hose Reel
- Diesel Transfer Hand Crank Reel

P53

P53
P53



Flow Meters

- In-Line Digital Flow Meter
- Mechanical Diesel Flow Meter
- Mechanical Petrol Flow Meters

P54

P54
P54
P54



Fuel Nozzles

- Manual Fuel Nozzles
- Automatic Fuel Nozzles
- Truck Stop Fuel Nozzles
- High Volume Nozzles

P55-57

P55
P56-57
P57
P57



Fuel Transfer Accessories

- Fuel Delivery Hose
- Swivels
- Breakaway Valves
- Fuel Nozzle Covers
- Fuel Fitter
- Elbows

P51, P58-60

P51
P58
P59
P59
P60
P60





Fuel Transfer Pumps

12, 24 & 240 Volt Diesel Transfer Kit

- Simple and efficient for transferring fuel from the drum or tank in any situation
- 2" quick change coupling connection makes it easy to move from one drum to another
- Manual nozzle & swivel
- 4 metre delivery hose
- 2 metre telescopic steel suction tube
- Self priming pump with integral bypass
- Duty cycle: 30 minutes
- Not suitable for petrol
- DITI10304019 - Suitable for Bio-diesel
- DITI10305704, DITI10307600 - Extra heavy duty construction



DITI10305704, DITI10307600



DITI10305619, DITI10307207, DITI10307000, DITI10305610, DITI10305611



DITI10304017, DITI10304018, DITI10304019

MODEL	Flow Rate	Voltage (V)	Nozzle	Delivery Hose
DITI10304017	40 LPM	12 Volt	Manual	4 meters
DITI10304018	40 LPM	24 Volt	Manual	4 meters
DITI10304019 (Bio-diesel)	40 LPM	12 Volt	Manual	4 meters
DITI10305610	56 LPM	12 Volt	Manual	4 meters
DITI10305611	56 LPM	24 Volt	Manual	4 meters
DITI10305704	57 LPM	12 Volt	Manual	4 meters
DITI10307000	35-70 LPM	12/24 Volt	Manual	4 meters
DITI10307600	76 LPM	12 Volt	Manual	4 meters
DITI10305619	56 LPM	240 Volt	Manual	4 meters
DITI10307207	72 LPM	240 Volt	Manual	4 meters



Fuel Transfer Pumps

12 & 24 Volt Diesel Transfer Carry Kit



- Portable lightweight transfer pump
- Complete with manual nozzle, swivel, flexible suction hose and strainer
- Self priming pump with integral bypass, on/off switch and carrying handle
- Ideal for construction sites, boats and on the farm
- Duty cycle: 30 minutes
- Not suitable for petrol

MODEL	Flow Rate	Voltage (V)	Nozzle	Delivery Hose	Hose I.D
DIT110304010	40 LPM	12 Volt	Manual	4 meters	3/4"
DIT110304011	40 LPM	24 Volt	Manual	4 meters	3/4"

12, 24 & 240 Volt Diesel Pump Motor

- Self priming diesel transfer pump
- Integral bypass and strainer
- Duty cycle: 30 minutes
- Complete with 2 meter battery cable with clips and fuse (12 & 24V models only)
- DIT117510404 & DIT117510405 - Integrated carry handle
- Not suitable for petrol



DIT117510404, DIT117510405



DIT117530560, DIT117530561



DMA60



DKSK9155, DKSK9156



DIT117311200

MODEL	Flow Rate	Voltage (V)	Inlet	Outlet
DIT117510404	40 LPM	12 Volt	3/4" BSP	3/4" BSP
DIT117510405	40 LPM	24 Volt	3/4" BSP	3/4" BSP
DIT117530560	56 LPM	12 volt	1" BSP	1" BSP
DIT117530561	56 LPM	24 Volt	1" BSP	1" BSP
DMA60	60 LPM	240 Volt	1" BSP	1" BSP
DKSK9155	80 LPM	240 Volt	1" BSP	1" BSP
DKSK9156	100 LPM	240 Volt	1" BSP	1" BSP
DIT117311200	120 LPM	240 Volt	1" BSP	1" BSP



Fuel Transfer Pumps

12, 24 & 240 Volt Petrol Transfer Kit

- Heavy duty portable petrol transfer pump for 205 litre drums and storage tanks
- Complete with nozzle, nozzle holder and bypass valve
- Suitable for petrol, diesel, light oils, etc.
- 2" bung thread & telescopic suction tube
- DTUTFR700VG suitable for automatic nozzle (DHU026838) and Flow meter (DTUTFR807CMK)
- DTUTSD12012 & DTUTSD2402 - suitable for automatic nozzle (DHU337015)



DTUTSD1202, DTUTSD2402



DTUTFR700VG



DTUTFR701VELA

FUEL TRANSFER EQUIPMENT

MODEL	Flow Rate	Voltage (V)	Nozzle	Flow Meter	Delivery Hose
DTUTSD1202	57 LPM	12 Volt	Manual	-	4 metres
DTUTSD2402	57 LPM	24 Volt	Manual	-	4 metres
DTUTFR700VG	75 LPM	240 Volt	Manual	-	4 metres
DTUTFR701VELA	75 LPM	240 Volt	Automatic	Yes	4 metres



240 Volt Diesel Transfer Pump Station MODEL DMAETP60

- Self priming pump, with manual on/off switch
- Not suitable for petrol
- 4 digit flow metre
- Complete with integral bypass and built in strainer
- 1" BSP inlet
- Manual nozzle with 4 metres of delivery hose
- OPTIONAL: Automatic shut-off nozzle (DHUE159415), will require 3/4" x 1" BSP swivel (DKSK4110)

MODEL	Flow Rate	Voltage (V)	Nozzle	Delivery Hose
DMAETP60	60 LPM	240 Volt	Manual	4 metres



Fuel Transfer Pumps



240 Volt Diesel Pit Stop

- Complete with integral bypass and built in strainer
- Flow meter to measure fuel dispensing and total volume usage
- Nozzle holder that doubles as an on/off switch
- 1" BSP inlet/outlet
- Not suitable for petrol

MODEL	Fluid	Flow Rate	Voltage (V)	Meter	Nozzle	Delivery Hose
DIT110305640	Bio-Diesel	57 LPM	240 Volt	Mechanical	Automatic	4 meters
DIT110305603	Diesel	57 LPM	240 Volt	Mechanical	Automatic	4 meters
DIT110308003	Diesel	80 LPM	240 Volt	Mechanical	Automatic	4 meters



240 Volt Diesel Cabinet Pump

- Flow meter to measure fuel dispensing and total volume usage
- Italian manufactured and the body is fabricated entirely out of painted metal
- Nozzle holder that doubles as an on/off switch
- Self priming vane pump
- Easy to mount unit with mounting bracket fitted
- Inlet to unit 1" female BSP thread makes it easy to plumb
- Not suitable for petrol

MODEL	Flow Rate	Voltage (V)	Meter	Nozzle	Delivery Hose
DAF3060	60 LPM	240 Volt	Mechanical	Automatic	4 meters
DAF3080	80 LPM	240 Volt	Mechanical	Automatic	4 meters
DAF3100	100 LPM	240 Volt	Mechanical	Automatic	4 meters



240 Volt Diesel Management Pump

MODEL DOT8469

- Self priming pump complete with electric flow meter, automatic nozzle, 4 metres of filling hose, installed within a protective box
- Suitable for diesel and bio-diesel
- Diesel dispensing amounts can be preselected
- Up to 50 users
- Option of entering vehicle registration number and mileage
- Management of date and time of dispensing
- PIN-code access control as standard
- Optional key access control - 1 master key, 10 user keys, key reader with USB interface and PC software for wireless data transfer to the PC and PC software (DOT8706)
- Optional data transfer to PC by means of data transmission cable (DOT7890)
- Optional pedestal stand model DOT7888

MODEL	Flow Rate	Voltage (V)	Meter	Nozzle	Delivery Hose
DOT8469	70 LPM	240 Volt	Digital Meter	Automatic	4 meters



Fuel Transfer Tank System

Diesel Tank Transfer Kit



- Comprises of diesel transfer pump, double skin diesel storage tank, fuel nozzle and delivery hose
- High flow rate: 100 litre per minute
- Inside tank made of polypropylene
- Outside tank zinc coated steel sheet
- Integrated carry handles and fork lift raisers
- Leakage indicator and filling level indicator
- Not suitable for petrol
- Suitable for undercover storage
- Can be optioned with various other fuel transfer pumps to suit your needs

FUEL TRANSFER EQUIPMENT

MODEL	DOT7380KIT	DOT7881KIT
Tank capacity	1000 litre	1500 litre
Dimensions (l x w x h)	1280mm x 770mm x 1420mm	1630mm x 770mm x 1950mm
KIT BREAKDOWN		
240 Diesel Pump Kit	DKSK9204	DKSK9204
Storage tank	DOT7380	DOT7881
Suction hose	DITIPVC1000MF2	DITIPVC1000MF2
940mm suction tube	DITIWB10005	DITIWB10005
Bung adaptor	DITIBG00001	DITIBG00001
Top elbow nipple connector	DITIWBT00001	DITIWBT00001
Foot valve	DITIFV00001	DITIFV00001
Foot strainer	DITIFR00001	DITIFR00001
Top extension connection	DITIET10001	DITIET10001
Extension tube - 500mm	DITIET10500	DITIET10500
Extension foot connection	DITIWBT00001	DITIWBT00001

Fuel Delivery Hose



- 4 metre antistatic rubber hose with crimped ends

MODEL	Max Pressure	Hose I.D	A	B
DITI19138401	300psi	1"	1" BSP	1" BSP
DITI19136402	300psi	¾"	1" BSP	¾" BSP



Mobile Diesel Transfer Kits

Mobile Diesel Transfer Tank Kits

- 100 - 1200 litre mobile diesel transfer tanks
- Equipped with 40 LPM, 12 volt pump kit
- Auto-shut off nozzle and swivel
- 6 metre delivery hose
- 4 meter power cable & earth strap
- Diesel grade polyethylene construction
- Strong poly lid to protect pump compartment
- Lockable fully enclosed pump compartment for protection and security
- Splash resistant breather
- Manufactured from specifically formulated diesel grade polyethylene that meets International Regulation ECE R34.01 requirements
- Optional - Higher volume pumps can be fitted



12 Volt Pump Kit

High flow 40 litres per minute, 6 metre delivery hose and automatic nozzle



Storage Tank

Strong construction, with lockable fully enclosed pump compartment



Ball Baffle System

Reduces fluid movement for improved load stability during transit. Fitted on 800, 1000 & 1200 litre models.

MODEL	Capacity	Dimensions	Flow Rate	Voltage (V)	Nozzle	Delivery Hose
DT100	100 litre	800 x 680 x 465	40 LPM	12 Volt	Automatic	4 metre
DT200	200 litre	1150 x 820 x 565	40 LPM	12 Volt	Automatic	6 metre
DT200T	200 litre	800 x 680 x 710	40 LPM	12 Volt	Automatic	6 metre
DT400	400 litre	1150 x 820 x 780	40 LPM	12 Volt	Automatic	6 metre
DT440	440 litre	1700 x 880 x 620	40 LPM	12 Volt	Automatic	6 metre
DT600	600 litre	1700 x 880 x 740	40 LPM	12 Volt	Automatic	6 metre
DT800	800 litre	1700 x 1000 x 860	40 LPM	12 Volt	Automatic	6 metre
DT1000	1000 litre	1700 x 1000 x 1025	40 LPM	12 Volt	Automatic	6 metre
DT1200	1200 litre	1700 x 1000 x 1190	40 LPM	12 Volt	Automatic	6 metre



Hose Reels

Large Capacity Hose Reel



- Double arm hose reel
- Large reeling capacity
- Heavy duty steel construction with corrosion resistant powder coating
- Spring fully enclosed and lubricated
- Four-direction non-snag hose rollers reduce hose wear
- Guide arm adjustable, floor mount
- Multi-position ratchet lock and easy tension adjustment

MODEL	DITIM880206	DITIM880158	DITIM880304
Application	Oil, water & diesel	Oil, water & diesel	Oil, water & diesel
Inlet/Outlet (fitting)	¾"	1"	½"
Maximum pressure	1250psi	1000psi	2000psi
Hose I.D	¾"	1"	½"
Hose length	20 metres	15 metres	30 metres

Oil & Fuel Hose Reel



- Designed for industrial application where longer hose is required
- Constructed with heavy-duty powder coated steel
- Easy to install and maintain
- Conveniently keeps hose organized for a more efficient work area
- Transfer media: fuel & oil

MODEL	DITIHRM808106
Application	Diesel, petrol & oil
Inlet/Outlet (fitting)	¾"
Maximum pressure	1250psi
Hose I.D	¾"
Hose length	10 metres



Fuel Flow Meters



In-Line Digital Diesel Flow Meter

MODEL DIT15221002

- Suitable for diesel and kerosene
- 5 digit easy to read digital LCD display
- Simple, reliable, compact & economical
- Easy to install either in line or at the end of the delivery hose
- Measures in litre, gallon, pint and quart
- Available in Aluminium or Plastic
- Also available: UREA/DEF Inline flow meter - DIT15221005

MODEL	Flow Rate	Max Pressure	Inlet/Outlet	Accuracy
DIT15221002	10-100 LPM	145psi	1" BSP	±0.5%



Mechanical Diesel Flow Meter

MODEL DIT1581400

- High capacity meter
- Reliable, easy to install and simple to calibrate in the field
- Suitable for diesel (not petrol)
- Large easy to read 4 digit display with 8 digit totaliser
- Ideal for gravity feed situations as well as use with electric pumps

MODEL	Flow Rate	Max Pressure	Inlet/Outlet	Accuracy
DIT1581400	20-120 LPM	50psi	1" BSP	±1%



Petrol Flow Meter

- Suitable for petrol, diesel, light oils, mineral spirits, heptane and hexane
- Large easy to read 3 digit display with 6 digit totaliser
- Weatherproof and corrosion resistant
- Ideal for gravity feed situations as well as use with electric pumps
- Not suitable for bleach, hydrochloric acid, ink, motor oil and salt water

MODEL	Flow Rate	Max Pressure	Inlet/Outlet	Accuracy
DTUTFR807CMK	19-76 LPM	50psi	¾" BSP	±1%
DTUT807CL1	19-76 LPM	50psi	1" BSP	±1%



Petrol High Flow Meter

- Suitable for petrol, diesel, light oils, mineral spirits, heptane and hexane
- Large easy to read 4 digit display with 8 digit totaliser
- Weatherproof and corrosion resistant
- Ideal for gravity feed situations as well as use with electric pumps
- Not suitable for bleach, hydrochloric acid, ink, motor oil, and salt water

MODEL	Flow Rate	Max Pressure	Inlet/Outlet	Accuracy
DTUT901L	19-151 LPM	50psi	1" BSP	±2%
DTUT901L1.5	19-151 LPM	50psi	1½" BSP	±2%



Manual Fuel Nozzles



Manual Fuel Nozzle

- Solid aluminium cast construction
- Brass swivel
- Suitable for gravity feed and electric pumps
- Built in spout hook

MODEL	Fluid Type	Inlet
DKSK9151A	Leaded/Diesel	1" BSP
DKSK9150	Unleaded	1" BSP



Plastic Manual Nozzle

MODEL DJ5115

- Polypropylene construction
- Suitable for fuel, water, solvents
- Built in spout hook
- 1" BSP brass inserted thread



Manual High Volume Fuel Nozzle

MODEL DHEA1250

- High flow rate of 0-260 litres per minute
- Light weight and easy to operate
- Solid aluminium cast construction with stainless steel spout
- Suitable for gravity feed and electric pumps
- 1½" BSP Inlet/Outlet



Automatic Fuel Nozzles



Automatic Fuel Nozzle

MODEL DMAMD20A1

- Automatic shut-off nozzle
- Suitable for petrol and diesel
- Flow rate up to 40 litres per minute
- Ideal for electric transfer pumps
- Fixed spout with hook
- Not suitable for gravity feed applications
- 3/4" BSP inlet



Automatic Fuel Nozzle

- Automatic shut-off nozzle
- Suitable for petrol and diesel
- Flow rate up to 60 litres per minute
- Not suitable for gravity feed applications

MODEL	Fluid Type	Inlet
DZHTDL11A	Leaded	3/4" BSP
DZHTDU11A	Unleaded	3/4" BSP



Automatic High Flow Fuel Nozzle

MODEL DHU026838

- Automatic shut-off nozzle
- Suitable for diesel
- High flow rate up to 100 litres per minute
- Full nozzle guard and lever cover
- Accu-Flo poppet allows accurate dispensing
- Not suitable for gravity feed applications
- 1" BSP inlet
- OPTIONAL: spout hook model number DKSK9193
- OPTIONAL: 1" to 1" swivel model number DKSK4115



Automatic Fuel Nozzle

MODEL DHU337015

- Automatic shut-off nozzle
- Suitable for petrol and diesel
- Flow rate of 65 litres per minute
- Suitable for 12 & 24 volt electric pumps
- Fixed spout with hook
- Strong and durable construction
- Not suitable for gravity feed situations
- 3/4" BSP inlet



High Volume Fuel Nozzles



Heavy Duty Automatic High Flow Fuel Nozzle

MODEL DMAMD120

- Heavy duty automatic shut-off nozzle
- Suitable for diesel
- High flow rate up to 120 litres per minute
- Full nozzle guard and lever cover
- Not suitable for gravity feed applications
- 1" BSP inlet



Truck Stop Fuel Nozzle

MODEL DHU173338

- Automatic shut-off truck stop nozzle
- Suitable for diesel
- High flow rate up to 280 litres per minute
- Valve shuts off when nozzle is horizontal or drops on to the ground
- Not suitable for gravity feed applications
- 1" BSP inlet
- OPTIONAL: 1" to 1" swivel model number DKSK 4115



High Volume Fuel Nozzle

MODEL DZHZZN1290

- Automatic shut-off nozzle
- Suitable for diesel
- High flow rate up to 240 litres per minute
- Right angle grip design provides larger lever area for better grip
- Dual poppets make it easy to open against high inlet pressure
- Not suitable for gravity feed applications
- 1½" BSP inlet



Super High Volume Fuel Nozzle

MODEL DHU169038

- Automatic shut-off nozzle
- Suitable for diesel
- High flow rate up to 450 litres per minute
- Dual poppets make it easy to open against high inlet pressure
- Extra large opening accommodates gloves
- Two position hold open latch and right angle design to fit close to walls or corners
- Not suitable for gravity feed applications
- 1½" BSP inlet



Fuel Transfer Accessories



Fuel Nozzle Hook

MODEL DKSK9193

- Plastic spout hook
- Allows easy storage of nozzles after use
- Required for automatic nozzles to fit to electric fuel pumps
- Suitable for automatic fuel nozzles (DHU026838)



Straight Swivel

- Straight swivel suitable for self serve applications
- To suit automatic fuel nozzles
- Brass construction with BSP threads

MODEL	Inlet	Outlet
DKSK4110	3/4" BSP Female	1" BSP Male
DKSK4115	1" BSP Female	1" BSP Male



Straight Swivel

- Straight swivel suitable for self serve applications
- To suit automatic fuel nozzles
- Aluminium construction with BSP threads

MODEL	Inlet	Outlet
DMANS111	3/4" BSP Female	3/4" BSP Male
DMANS113	3/4" BSP Female	1" BSP Male
DMANS131	1" BSP Female	3/4" BSP Male
DMANS133	1" BSP Female	1" BSP Male



Universal Multi Plane Swivel

- Multi plane swivel designed for self serve applications
- Full 360° spherical rotation for easy movement
- High flow rate due to laminar flow design
- Double 'O' ring seals at each swivel to provide long life and low temperature performance
- High strength step shoulder bearing diameters and impact absorbing stops

MODEL	Inlet	Outlet
DHU3590	3/4" BSP Female	3/4" BSP Male
DHU3306	1" BSP Female	1" BSP Male



Fuel Transfer Accessories

Reconnectable Breakaway Valve



- Fuel stops on both sides of separation
- Separates under 90kg force reducing damage to equipment
- Internal pressure balancing chamber prevents line shock nuisance separations
- Retains UL listing even after separation and reconnection
- Unit quickly and easily snaps back together after separation

MODEL	Inlet	Outlet
DHU3385	3/4"	3/4"
DHU3076	1"	1"

Breakaway Valve

MODEL DHU2774



- Non reconnectable breakaway valve
- Unit is lightweight, inexpensive and disposable
- Separates under 113 kg force reducing damage to equipment
- Instant closing butterfly valve design
- Stops flow on both sides of separation
- 3/4" BSP thread

High Flow Fuel Nozzle Accessories



- Suitable for fuel nozzle DHU026838
- Other colours available on request

MODEL	Description
DHU5215	Spout assembly without thread (new style)
DHU0740	Spout assembly with thread (old style)
DHU0554	Full grip guard (green)
DHU1807	Waffle guard (green)
DHU2574	Trigger cover

Truck Stop Fuel Nozzle Accessories



- Suitable for fuel nozzle DHU173338
- Other colours available on request

MODEL	Description
DHU2279	Spout assembly
DHU4740	Full grip guard (green)
DHU1808	Waffle guard (green)
DHU2573	Trigger cover



Fuel Transfer Accessories



Fuel Filter

MODEL DBNS10

- Fuel filter & bowl
- Durable weather and rust resistant unit for fuel tanks and diesel pumps
- 1" BSP ports
- Low cost replacement filters
- 10 micron filter
- Valve for water removal
- Transparent polycarbonate bowl
- Replacement filter DBNS20



Filter Kit - DBNS20



Brass Barb Tail

- Suitable for 3/4" & 1" hose
- Barb tails with 'O' ring seal
- Not sui with DBNS10 filter (model DBN2525 is suitable)

MODEL	Inlet	Outlet
DKSK9142	3/4" BSP	3/4" BSP
DKSK9143	1" BSP	3/4" BSP
DKSK9144	3/4" BSP	1" BSP
DKSK9145	1" BSP	1" BSP



Elbows

MODEL	Inlet	Outlet
DBE2020MF	3/4" BSP Male	3/4" BSP Female
DBE2525MF	1" BSP Male	1" BSP Female
DBE2020F	3/4" BSP Female	3/4" BSP Female
DBE2525F	1" BSP Female	1" BSP Female



Elbow Extension

- 150mm meter elbow extension
- Required for joining meter to electric pump
- Galvanised steel construction
- BSP thread

MODEL	Elbow	Extension
DKSK9190	3/4" BSP	3/4" BSP
DKSK9191	1" BSP	1" BSP

UREA/DEF EQUIPMENT

UREA/DEF
EQUIPMENT





Table of Contents

UREA/DEF Equipment

P63-67

UREA/DEF IBC Pump System

- UREA/DEF Electric IBC Pump System

P63

P63



UREA/DEF Electric Pumps

- UREA/DEF 12 & 24 Volt DC Pump Kit
- UREA/DEF 230V Transfer AC Pump
- UREA/DEF 12 & 24 DC Pump

P64-65

P64
P64
P65



UREA/DEF Diaphragm Pump

- UREA/DEF Diaphragm Pump

P65

P65



UREA/DEF Hose Reel

- UREA/DEF Hose Reel

P65

P65



UREA/DEF Meters & Nozzles

- UREA/DEF Inline Flow Meter
- UREA/DEF Manual Nozzle
- UREA/DEF Automatic Nozzle

P66

P66
P66
P66



UREA/DEF Accessories

- SEC Connection
- Rubber Hose

P67

P67
P67



UREA/DEF Hand Pumps

- Rotary Action
- Lever Action

P67

P67
P67





UREA/DEF IBC Pump Systems

UREA/DEF IBC Pump System

- Flow rate up to 25 Litres per minute
- Includes a powder coated steel wall mounting plate making it easy to install
- 300W pump
- Mounted on a bracket that can be easily removed from tank to tank
- 6 metre delivery hose
- 1.5 metre suction hose with SEC coupling
- Nozzle holder with drip container
- IBC not included



DIT110302500



DIT110302502



DIT110302504

MODEL	Pump Model	Voltage	Suction Hose	Delivery Hose	Nozzle	Flow Meter	Hose Tails & Clamp	Bracket	SEC Connection
DIT110302500	17350250	240V	1.5M	6M	Manual	No	Yes	Yes	No
DIT110302502	17350250	240V	1.5M	6M	Manual	Yes	Yes	Yes	No
DIT110302504	17350250	240V	1.5M	6M	Auto	Yes	Yes	Yes	No



UREA/DEF Electric Pumps

UREA/DEF DC Pump Kit

- Portable UREA/DEF transfer pump, with membrane pump complete with a 12/24V electric motor



MODEL	Pump Model	Voltage	Suction Hose	Delivery Hose	Nozzle	Flow Meter	Hose Tails & Clamp	Bracket	SEC Connection
DIT110302506	17550250	12V	1.5M	6M	Manual	No	Yes	No	No
DIT110302507	17550253	24V	1.5M	6M	Manual	No	Yes	No	No

UREA/DEF Transfer AC Pump

- Portable UREA/DEF transfer pump, with membrane pump complete with a 240V electric motor
- This solution provides a reliable industrial pump together with self priming capabilities



MODEL	Voltage	Flow Rate	RPM	Power	Max. Working Pressure	Inlet/Outlet
DIT117350250	240V	6.6GPM / 25LPM	2800	300W	2.0 AMP	3/4"



UREA/DEF Hose Reel & Diaphragm Pump

UREA/DEF DC Pump



- Portable UREA/DEF transfer pump, with membrane pump complete with 12/24V electric motor
- This solution provided a reliable industrial pump together with self priming capabilities

MODEL	Voltage	Flow Rate	RPM	Power	Max. Working Pressure	Inlet/Outlet
DIT117550250	12V	6.6GPM / 25LPM	2800	180W	18 AMP	3/4"
DIT117550253	24V	6.6GPM / 25LPM	3380	180W	12 AMP	3/4"

UREA/DEF EQUIPMENT

UREA/DEF Hose Reel

MODEL DITIHL8080861727



- Stainless steel full flow swivel, Viton made seals and EPDM hose designed to transfer UREA/DEF perfectly as well as diesel fuel
- Heavy gauge steel frame includes dramatically flanged edges and stiffening ribs for lighter weight, stronger components for ease of installation
- Inlet/Outlet: 3/4", Hose I.D.:3/4"
- Hose Length: 26ft/8M
- Working Pressure: 300PSI / 20BAR

UREA/DEF Double Diaphragm Pump

MODEL DIT117050601V



- Air operated diaphragm pump, ideal to transfer high volumes of UREA/DEF (AUS32) from drums or tanks
- Also suitable for transferring water-based chemicals, acid and alkaline solutions
- Heavy duty plastic construction with ground capability to eliminate static discharge
- Viton seals
- Maximum diameter solid: 1/8"
- Comes with 1/2" reducer, if used the flow rate will reduce to 45 LPM

MODEL	Flow Rate	Max Pressure	Inlet/Outlet	Air Inlet
DIT117150601V	60 LPM	115psi	3/4"	1/4"



UREA/DEF Inline Flow Meter

MODEL DITI15221005

- Easy to install either in line or at the end of the delivery hose
- High flow rate up to 100 Litres per minute
- Inlet/Outlet: 1" BSP
- Easy to read LCD display
- Measures in litre, gallon, pint and quart
- Simple, reliable, compact & economical
- Adjustable calibration



UREA/DEF Manual Nozzle

MODEL DITI18311006

- Adaptable to electric pump and gravity flow tank
- Plastic nozzle with stainless steel spout
- Flow rate: 16GPM / 60LPM
- Inlet: 3/4"
- Ideal for UREA/DEF dispensing



UREA/DEF Automatic Nozzle

MODEL DITI18311009

- Lightweight nozzle made from high quality plastic
- Automatic shut off nozzle
- Flow rate: 2 - 14GPM / 8 - 50LPM
- Inlet: 3/4"
- Diameter of spout: 3/4"
- Stainless steel spout
- Ideal for UREA/DEF dispensing



UREA/DEF Stainless Steel Automatic Nozzle

MODEL DITI18311008

- Stainless steel structure with viton seal
- Automatic shut-off nozzle
- Flow rate: 2 - 14GPM / 8 - 50LPM
- Inlet: 3/4"
- Diameter of spout: 3/4"
- Ideal for UREA/DEF dispensing



205 Litre UREA/DEF Lever Pump



- Suitable for (AUS32)
- Lightweight and economical
- Suction tube suitable for 60 and 205 litre drums
- DJPP200RP - 2" bung adaptor
- DJPPS200LP - 2" thread

MODEL	DJPP200RP	DJPPS200LP
Action Type	Rotary	Lever
Revolutions / Strokes per litre	3	4
Suction Tube	3 piece	2 piece
Construction	Polypropylene	Polypropylene (S/S Shaft)
Suitable for	, acid, alkaline, hydraulic oil	, water-based chemicals, acid, alkaline & hydraulic oil

UREA/DEF Rubber Hose

- EPDM rubber hose
- Inner Dimension: 3/4"
- Hose Length: 6 metres



MODEL DITI19136407

UREA/DEF IBCKIT Suction Tube Assembly

- Suitable for UREA/DEF
- 108mm in length
- I.D 25mm
- Connects with SEC Connection (MODEL DITI17940040)



MODEL DITI17940042



UREA/DEF SEC Connection

- Suction connection
- 2" BSP Thread
- 1" Barb

MODEL DITI17940040



Notes

STM Australia Pty Ltd

Notes

GREASE EQUIPMENT



GREASE
EQUIPMENT



Grease Equipment

P71-88

Grease Guns

- Lever Action Grease Guns
- Pistol Grip Grease Guns
- Air Grease Gun
- 18 Volt Grease Gun

P71-73

- P71
- P72
- P73
- P73



Grease Units

- Grease Gun Bulk Filler
- 2.5Kg Grease Units
- 20Kg Grease Unit

P73-74

- P73
- P74
- P74



Grease Control Gun

- Digital Grease Control Gun

P75

- P75



Air Operated Grease Pumps

- 10:1 High Volume Grease Pumps
- 50:1 Grease Pumps
- 50:1 High Volume Grease Pumps
- Portable Grease Pump Kits

P75-79

- P75
- P76
- P77
- P78-79



Grease Accessories

- Drum Covers & Follower Plates
- Grease Couplers
- Grease Control Valves
- Flexible outlet hose and Rigit Outlet Pipe
- Grease Needles

P80-83

- P80
- P81
- P81
- P81-82
- P82-83



Grease Nipples

- Grease Nipples
- Grease Nipple Display Packs
- Grease Nipple Thread Tester
- Grease Nipple Assortment Kits
- Grease Nipple Header Blocks

P84-88

- P84-86
- P87
- P87
- P88
- P88





Grease Guns

Lever Action Grease Guns

- Lever action grease guns for higher pressure performance
- Cartridge model
- Rubber handle for maximum grip
- Non-slip finish
- DG467 - Heavy duty construction with adjustment for high pressure / high volume

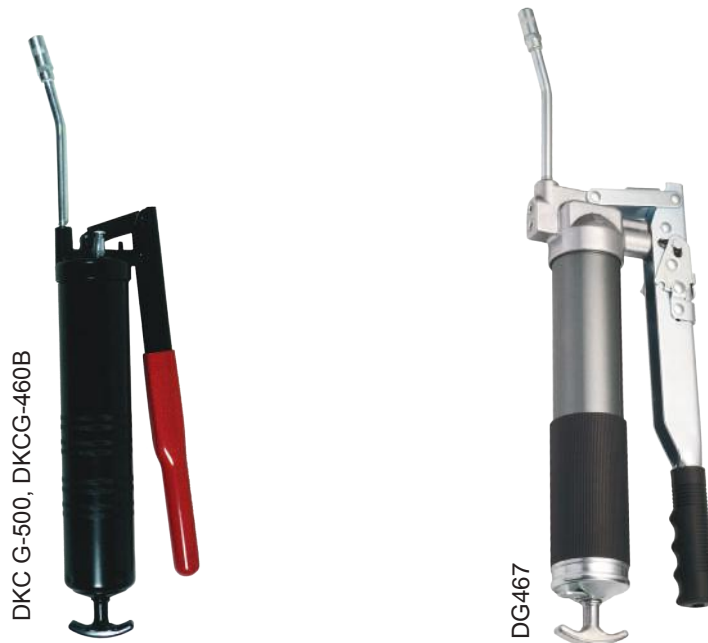

Demonstration

MODEL	DKCG-500	DKCG-460B	DG467
Cartridge	450 gram	400 gram	450 gram
Class	Economy	Economy	High pressure / High volume
Grams per stroke	0.7 grams	0.7 grams	0.35 / 2.5 grams
Working pressure	4500psi	4500psi	10000psi / 2000psi
Rigid outlet pipe	150mm	150mm	150mm
4 jaw coupler	Yes	Yes	Yes
Air bleeder valve	Yes	Yes	Yes
Bulk fill valve	-	-	Yes



Grease Guns

Pistol Grip Grease Guns

- Pistol grip grease gun for one hand confined spaces
- Cartridge model
- Solid construction
- Rubber handle for maximum grip
- Non-slip finish
- DKCG-483N - Adjustment for high pressure (10cc) / high volume (16cc)
- DG488N - • Easily change from pistol grip for confined narrow spaces to lever action for two hand high pressure performance



DKCG-481N, DKCG-480N



DKCG-483N



DKCG-481LN



DG488N



Smart Handle Extension

Easily converts from pistol grip action to lever action

MODEL	DKCG-481N	DKCG-480N	DKCG-481LN	DKCG-483N	DG488N
Cartridge	450 gram	400 gram	450 gram	450 gram	450 & 400 gram
Class	Economy	Economy	Heavy duty variable stroke	High pressure / High volume	4-in-1 grease gun
Grams per stroke	0.7 grams	0.7 grams	0.7 grams	0.45 / 0.7 grams	0.6 grams
Working pressure	4500psi	4500psi	8000psi	12000psi	10000psi
Rigid outlet pipe	-	-	-	-	150mm
Flexible outlet hose	250mm	250mm	250mm	250mm	450mm
4 jaw coupler	Yes	Yes	Yes	Yes	Yes
Air bleeder valve	Yes	Yes	Yes	Yes	Yes
Bulk fill valve	Yes	Yes	Yes	Yes	Yes
Lever hold down clamp	-	-	Yes	Yes	Yes



Grease Guns



360° Pistol Grip Air Grease Gun

MODEL DG508CL

- Continuous flow air grease gun
- 450 gram cartridge
- 360° angle free rotating design for added flexibility to get to any grease fitting
- Working pressure 6000psi
- Heavy duty construction
- Comes with 250mm flexible outlet hose
- Air bleeder valve & bulk fill valve
- 4 jaw coupler
- Butterfly lock screw for a secure grip handle



18 Volt Grease Gun

MODEL DG83231

- 240 volt charger to 18 volt DC with 1 hour fast charge
- Heavy duty construction
- 450 gram cartridge & bulk fill
- Working pressure 9500psi
- Comes with 1 metre high pressure flexible hose
- 4 jaw coupler and grip support on nipple end
- Supplied with extra battery & robust carry case
- Carry strap

20kg Grease Gun Bulk Filler

MODEL DG93411

- 20kg grease pump
- Suitable for bulk filling of manual or electric hand grease guns
- Fast, reload grease guns in less than a minute
- Durable cast aluminium alloy pump outlet body
- Nipple allows bulk fill to valves with diameters of 9mm and 12.5mm
- Rubber follower plate





Grease Units

2.5kg and 20kg Grease Unit

- Ideal when lubricating equipment frequently or in bulk amounts
- 360° swivel at hand piece end
- DG9811, DG9812 - Easy 2 setting hand piece for high pressure and high volume
- DROX001 - Detachable hand piece



DG9812



DG9811



DROX001

MODEL	DG9811	DG9812	DROX001
Drum application	2.5kg	20kg	2.5kg
Operation	Foot operated spring plunger	Hand operated	Hand operated
Shots delivered	Up to 30	Up to 60	Up to 100
Working pressure	10000psi	10000psi	5000psi
Hose length	3 metres	3 metres	2 metres
4 jaw coupler	Yes	Yes	3 jaw coupler
Detachable hand piece	-	-	Yes



Grease Control Gun

Digital Grease Control Valve

MODEL DIT18213010

- Positive control of high pressure lubricants
- Measures in millilitre, litre, gallon and kilogram
- 4 digit easy to read display with low battery indicator
- Powered by 2 x AA battery (1.5V x 2)



MODEL	DIT18213010
Inlet connection	1/4" BSP
Maximum pressure	9000psi
Precision	±2%

GREASE EQUIPMENT

10:1 High Volume Air Operated Grease Pump

- High volume grease pump for use over short distances
- Suitable for 180kg drums
- Working pressure 1,160psi
- Flow rate of 10kg per minute
- Diameter of suction tube 55mm
- Suction tube length 950mm
- Can be supplied with follower plate (DO80684) and drum lid (DO80580)



MODEL	DO81882
Drum application	180kg
Pressure ratio	10:1
Working pressure	1,160psi
Max flow rate (per min)	10kg
Air inlet connection	1/4" BSP Female
Fluid connection	1/4" BSP Male
Follower plate (supplied seperately)	DO80684
Drum lid (supplied seperately)	DO80580



Air Operated Grease Pumps

50:1 Air Operated Grease Pump

- Double action pump for high pressure grease dispensing
- For dispensing grease of all types short and long distances at high pressure
- Non-corrosive design for long life
- Compatible with integrated lubrication systems
- Compatible with different sizes of grease drums in the market



DIT11701501

DIT11701502

DIT11701503

MODEL	DIT11701501	DIT11701502	DIT11701503
Drum application	20kg	60kg	180kg
Pressure ratio	50:1	50:1	50:1
Air inlet pressure	70-115psi	70-115psi	70-115psi
Working pressure	5600psi	5600psi	5600psi
Air consumption	@ 115psi 4.3 CRM	@ 115psi 4.3 CRM	@ 115psi 4.3 CRM
Max flow rate (per min)	800g	800g	800g
Suction tube diameter	30mm	30mm	30mm
Suction tube length	480mm	740mm	940mm
Air inlet connection	¼" BSP Female	¼" BSP Female	¼" BSP Female
Grease outlet connection	¼" BSP Male	¼" BSP Male	¼" BSP Male



50:1 High Volume Air Operated Grease Pump

- Heavy duty double action pump provides continuous flow operation
- For dispensing grease of all types short and long distances at high pressure
- Rugged inlet cage withstands demanding environments
- High flow capability, stable function



GREASE EQUIPMENT

MODEL	DIT117125030	DIT117125050	DIT117125060
Drum application	20kg	60kg	180kg
Pressure ratio	50:1	50:1	50:1
Air inlet pressure	70-180psi	70-180psi	70-180psi
Working pressure	9000psi	9000psi	9000psi
Air consumption	@ 115psi 21.6 CRM	@ 115psi 21.6 CRM	@ 115psi 21.6 CRM
Max flow rate (per min)	1.8kg	1.8kg	1.8kg
Suction tube diameter	32mm	32mm	32mm
Suction tube length	480mm	740mm	940mm
Air inlet connection	¼" BSP Female	¼" BSP Female	¼" BSP Female
Grease outlet connection	¼" BSP Male	¼" BSP Male	¼" BSP Male



Air Operated Grease Pumps

20kg, 60kg & 180kg Air Operated Grease Kits

- The most economical & complete combination for dispensing grease
- Complete set of fluid transfer accessories gives the end user a trouble-free using experience
- Standard model includes 50:1 pump, trolley, follower plate and drum cover, connection hose, 'Z' swivel and control gun
- DIT11700512 can be used for 16 Kg plastic pails, will need to order additional follower plate (DJL4321KIT) with diameter of 285mm



DIT11700512



DIT11700536

DIT11700524



DIT11700536R

MODEL	DIT11700512	DIT11700524	DIT11700536	DIT11700536R
Drum application	20kg	60kg	180kg	180kg
Pressure ratio	50:1	50:1	50:1	50:1
Working pressure	8700psi	8700psi	8700psi	8700psi
50:1 Pump	DIT11701501	DIT11701502	DIT11701503	DIT11701503
Control gun	DIT11785701 - 1/4" BSP	DIT11785701 - 1/4" BSP	DIT11785701 - 1/4" BSP	DIT11785701 - 1/4" BSP
Drum cover	DIT11709002 - Ø310mm	DIT11709005 - Ø420mm	DIT11709006 - Ø600mm	DIT11709006 - Ø600mm
Follower plate	DIT11709012 - Ø310mm	DIT11709015 - Ø410mm	DIT11709016 - Ø585mm	DIT11709016 - Ø585mm
'Z' swivel	DIT11785702 - 1/4" BSP	DIT11785702 - 1/4" BSP	DIT11785702 - 1/4" BSP	DIT11785702 - 1/4" BSP
Trolley	DIT11708001	DIT11708001	DIT11708002	DIT11708003
Hose Reel	-	-	-	DIT1H860152
Hose assembly	DIT11762213 - 1/4" x 4m	DIT11762213 - 1/4" x 4m	DIT11762213 - 1/4" x 4m	DIT11762207 - 1/4" x 2m



Air Operated Grease Pumps

Heavy Duty 20kg, 60kg & 180kg Air Operated Grease Kits

- Ideal for transfer of grease in high volume and long distance
- The most economical & complete combination for dispensing grease
- Complete set of fluid transfer accessories gives the end user a trouble-free using experience
- Standard model includes 50:1 pump, drum trolley, follower plate and drum cover, connection hose, 'Z' swivel and control gun
- DIT110250112 can be used for 16 Kg plastic pails, will need to order additional follower plate (DJL4321KIT) with diameter of 285mm



DIT110250112



DIT110250212



DIT110250322



DIT110250332

GREASE EQUIPMENT

MODEL	DIT110250112	DIT110250212	DIT110250322	DIT110250332
Drum application	20kg	60kg	180kg	180kg
Pressure ratio	50:1	50:1	50:1	50:1
Working pressure	8700psi	8700psi	8700psi	8700psi
50:1 Pump	DIT117125030	DIT117125050	DIT117125060	DIT117125060
Control gun	DIT118212050 - 1/4" BSP	DIT118212050 - 1/4" BSP	DIT118212050 - 1/4" BSP	DIT118212050 - 1/4" BSP
Drum cover	DIT119331002 - Ø310mm	DIT119342002 - Ø420mm	DIT119360002 - Ø600mm	DIT119360002 - Ø600mm
Follower plate	DIT119431002 - Ø310mm	DIT119441002 - Ø410mm	DIT119458502 - Ø585mm	DIT119458502 - Ø585mm
'Z' swivel	DIT11785702 - 1/4" BSP	DIT11785702 - 1/4" BSP	DIT11785702 - 1/4" BSP	DIT11785702 - 1/4" BSP
Trolley	DIT11708001	DIT11708001	DIT11708002	DIT11708003
Hose Reel	-	-	-	DIT117860152 - 15m
Hose assembly	DIT11762213 - 1/4" x 4m	DIT11762213 - 1/4" x 4m	DIT11762213 - 1/4" x 4m	DIT11762207 - 1/4" x 2m



Grease Accessories

Standard Grease Drum Covers & Follower Plates

- The drum cover keeps dust and impurities from contaminating the grease
- Keeps the pump in a vertical position for optimum operation
- Lightweight & easy to install
- The follower plate is indispensable when using heavy grease, it is pulled toward the bottom of the drum by the vacuum that is created by the pump
- Follower plates to fit pumps with various sized suction tube diameters are available
- DJL4321KIT comes with 4 central sleeve options to suit different suction tube diameters (1", 1 1/8", 1 1/4", 1 3/8") and removal of sleeve will allow pump diameter of 38.6mm



DJL4321KIT

Drum cover	Drum Cover Diameter	Follower Plate	Follower Plate Diameter	Drum Application
DIT11709001	280mm	DIT11709011	265mm	12-20kg
DIT11709002	310mm	DIT11709012	310mm	16-30kg
DIT11709003	350mm	DIT11709013	340mm	20-30kg
DIT11709004	385mm	DIT11709014	370mm	50-60kg
DIT11709005	420mm	DIT11709015	410mm	50-60kg
DIT11709006	600mm	DIT11709016	585mm	180-220kg
DG907384	600mm	DG0102115	585mm	180-220kg
		DJL4321KIT	285mm	16kg

Heavy Duty Grease Drum Covers & Follower Plates



Drum cover	Drum Cover Diameter	Follower Plate	Follower Plate Diameter	Drum Application
DIT119328002	280mm	DIT119426502	280mm	12-20kg
DIT119331002	310mm	DIT119431002	310mm	16-30kg
DIT119335002	350mm	DIT119434002	340mm	20-30kg
DIT119338502	385mm	DIT119437002	370mm	50-60kg
DIT119342002	420mm	DIT119441002	410mm	50-60kg
DIT119360002	600mm	DIT119458502	585mm	180-220kg



Grease Accessories



Grease Hose Assemblies

- SAE 100 R2
- Working pressure 5000psi
- Male thread fixed / female thread swivel

MODEL	Length	Inlet/Outlet
DIT11762205	1.5 metres	¼" BSP
DIT11762207	2 metres	¼" BSP
DIT11762213	4 metres	¼" BSP
DIT11762233	10 metres	¼" BSP
DIT11762250	15 metres	¼" BSP

Grease Drum Cover

MODEL DO80580

- Drum cover keeps dust and impurities from contaminating the grease
- Keeps the pump in the vertical position for optimum operation
- Lightweight and easy to install
- Suitable for 180kg drum application
- Suitable for pump with 55mm suction tube (DO81882)
- Matching follower plate (DO80684)



Grease Follower Plate

MODEL DO80684

- The follower plate is indispensable when using heavy grease, it is pulled toward the bottom of the drum by the vacuum that is created by the pump
- Lightweight and easy to install
- Suitable for 180kg drum application
- Suitable for pump with 55mm suction tube (DO81882)
- Matching drum cover (DO80580)



GREASE EQUIPMENT



MODEL	Description
DO88450	• 4 jaw 90° coupler, ⅛" BSP female
DO88452	• Button head coupler, ⅛" BSP female, suits ⅝" button head nipples
DIT118212050	• Heavy duty grease control valve • Provides positive control of high pressure lubricants • ¼" BSP
DIT11785701	• Grease control valve, ¼" BSP female
DIT11785701H	• 18" heavy duty ¼" flexible hose with coupler, ⅛" BSP male • 5600psi working pressure SAE 100R2AT, 18000psi burst pressure • Suitable for high pressure grease pumps



Grease Accessories



MODEL	Description
DG407	<ul style="list-style-type: none"> • Air pocket release valve • Suitable for air & electric grease guns • Quickly & easily removes air pockets from grease gun head for optimal performance • 1/8" BSP Inlet/outlet
DITI1785701R	<ul style="list-style-type: none"> • Rigid tube with coupler • 1/4" BSP Male
DITI1785701F	<ul style="list-style-type: none"> • Standard 4 jaw grease coupler, 1/8" BSP female
DITI1785702	<ul style="list-style-type: none"> • 'Z' swivel 1/4" BSP male x 1/4" BSP female • High pressure 8700psi
DKCH12	<ul style="list-style-type: none"> • 12" nylon hose with coupler, 1/8" BSP male • 4500psi working pressure, 12000psi burst pressure • Suitable for manual and air hand operated grease guns
DKCH18	<ul style="list-style-type: none"> • 18" nylon hose with coupler, 1/8" BSP male • 4500psi working pressure, 12000psi burst pressure • Suitable for manual and air hand operated grease guns
DKCGA-011	<ul style="list-style-type: none"> • Heavy duty grease coupler, 1/8" BSP female, 10000psi
DKCGA-012	<ul style="list-style-type: none"> • 360° swivel coupler, 1/8" BSP female • Suitable for hand operated grease guns
DKCGA-013	<ul style="list-style-type: none"> • 90° right angle coupler, 1/8" BSP female • Suitable for hand operated grease guns
DG31001	<ul style="list-style-type: none"> • Grease Nipple Cap
DKCGA003	<ul style="list-style-type: none"> • Needle tip adaptor with nipple end, Ø1/8" x 7/16" needle



Grease Accessories



MODEL	Description
DJL0311	<ul style="list-style-type: none"> Remove worn & broken grease fittings Built-in hardened tap for re-tapping holes Easy Out Tools For fittings with threads of 1/4" & 1/8"
DKCGA008	<ul style="list-style-type: none"> Needle nose dispenser, 1/8" BSP female, Ø3/16" diameter x 1/2" needle
DKCGA002	<ul style="list-style-type: none"> Seal-off dispenser, 1/8" BSP female
DKCGA005	<ul style="list-style-type: none"> Professional narrow needle nose dispenser, 1/8" BSP female, Ø1/8" x 1 1/2" needle
DKCGA001	<ul style="list-style-type: none"> Grease injector needle 16G x 1 1/2" needle with nipple
DKCGA006	<ul style="list-style-type: none"> Quick disconnect adaptor that fits over all couplers 4" overall length, 7/32" needle diameter x 9/16" long
DKCGA004	<ul style="list-style-type: none"> Narrow needle nose grease dispenser that fits over all couplers 5" overall length, 1/8" needle diameter x 1 3/8" long
DKCGA007	<ul style="list-style-type: none"> 4" Needle nose adaptor that fits over all couplers 7 1/4" overall length, 1/4" needle diameter x 4" long
DKCGA010	<ul style="list-style-type: none"> Grease gun wall bracket to suit 450 gram grease gun barrel of 27/16" diameter



Grease Nipples



Grease Nipples

Steel Model	Description
DG1	¼" BSF Str.
DG2	¼" BSW Str.
DGA5	¼" BSF 45°
DGA6	¼" BSW 45°
DGA8	¼" BSF 67½°
DGA9	¼" BSW 67½°
DGA10	¼" BSF 90°
DGA11	¼" BSW 90°
DG12	5/16" BSF Str.
DG13	5/16" BSW Str.
DG15	8m x 1.25 Str.
DGA16	5/16" BSF 45°
DGA19	8m x 1.25 45°
DGA20	5/16" BSF 67½°
DGT22	¾" BSF Hexagonal Button Head
DGA24	5/16" BSF 90°
DGA27	8m x 1.25 90°
DG28	½" NPT Str.
DG29	½" BSP Str.
DG30	½" BSP Str. Short Thread
DG31	¾" BSF Str.
DGA34	½" BSP 45°
DGA35	¾" BSF 45°
DGA37	½" NPT 67½°
DGA39	½" BSP 67½°
DGA41	¾" BSF 67½°
DGA43	½" NPT 90°
DGA44	½" BSP 90°
DGA45	¾" BSF 90°
DGT46	½" BSP Hexagonal Button Head



Grease Nipples



Grease Nipples

Steel Model	Description
DG47	¼" NPT Str.
DG48	¼" BSP Str.
DGA51	¼" NPT 45°
DGA52	¼" BSP 45°
DGT52	¼" BSP Hexagonal Button Head
DGA55	¼" NPT 67½°
DGA56	¼" BSP 67½°
DGA59	¼" NPT 90°
DGA60	¼" BSP 90°
DG77	¼" Drive Str. - No Ball
DG78	¼" Drive Str.
DG79	5/16" Drive Str.
DG80	5/16" Drive Str. - No Ball
DG113	¼" BSF Str. - 15/16" Long
DG114-U	¼" UNF Str. - 15/16" Long
DG119	6m x 1 Str. 29mm Long
DG123	¼" UNF Str. - 4mm Long Thread
DG128	¼" UNF Str. - 139/64" Long
DGA138	⅜" NPT 45°
DG143	3/16" Drive Str. - No Ball
DG161	6m x 1 Str.
DG162	8m x 1 Str.
DG163	6m x 1 Str. - Self Tapping
DGA165	6m x 1 90°
DGA168	6m x 1 45°
DGA169	8m x 1 90°
DGA172	8m x 1 45°
DG185	¼" UNF Str.
DGA187	¼" UNF 45°
DGA188	¼" UNF 67½°



Grease Nipples



Grease Nipples

Steel Model	Description
DGA189	¼" UNF 90°
DG190	5/16" UNF Str.
DGA192	5/16" UNF 45°
DGA193	5/16" UNF 67½°
DGA194	5/16" UNF 90°
DG195	¾" UNF Str.
DGA197	¾" UNF 45°
DGA198	¾" UNF 67½°
DGA199	¾" UNF 90°
DG200	10m x 1 Str.
DG201	6m x Str. - Drive
DG202	8m x Str. - Drive
DGA203	10m x 1 45°
DGA204	10m x 1 90°
DG205	10m x 1.5 Str.
DGA206	10m x 1.5 45°
DGA207	10m x 1.5 90°
DGT210	¼" UNF Standard Button Head
DGT320	¼" BSF Hexagonal Button Head
DGT324	½" NPT Hexagonal Button Head
DGT325	¼" NPT Hexagonal Button Head
DGT326	12m x 0.75 Hexagonal Button Head
DGT1015	10m x 1.5 Hexagonal Button Head
DG1020	¼" SAE - LT Str. - 1½" Long
DGA1215	12m x 1.5 90°
DG4788-1	½" BSP Industrial Round Head
DG4785-13	¼" BSP Industrial Round Head
DG4785-18	¾" BSP Industrial Round Head
DG6075	6m x 0.75 Str.



Grease Nipples

Grease Nipple Display Pack



MODEL	Description
DGP1	Display pack of 10 ¼" BSF Str. grease nipples
DGP2	Display pack of 10 ¼" BSW Str. grease nipples
DGP28	Display pack of 10 ⅝" NPT Str. grease nipples
DGP29	Display pack of 10 ⅝" BSP Str. grease nipples
DGPA34	Display pack of 10 ⅝" BSP 45° grease nipples
DGPA37	Display pack of 10 ⅝" NPT 67½° grease nipples
DGPA39	Display pack of 10 ⅝" BSP 67½° grease nipples
DGPA43	Display pack of 10 ⅝" NPT 90° grease nipples
DGPA44	Display pack of 10 ⅝" BSP 90° grease nipples
DGPT46	Display pack of 10 ⅝" BSP Hexagonal Button Heads
DGP48	Display pack of 10 ¼" BSP Str. grease nipples
DGPA52	Display pack of 10 ¼" BSP 45° grease nipples
DGPT52	Display pack of 10 ¼" BSP Hexagonal Button Heads
DGPA56	Display pack of 10 ¼" BSP 67½° grease nipples
DGPA60	Display pack of 10 ¼" BSP 90° grease nipples
DGPA138	Display pack of 10 ⅝" NPT 45° grease nipples
DGP161	Display pack of 10 6m x 1 Str. grease nipples
DGP162	Display pack of 10 8m x 1 Str. grease nipples
DGPA165	Display pack of 10 6m x 1 90° grease nipples
DGPA168	Display pack of 10 6m x 1 45° grease nipples
DGPA169	Display pack of 10 8m x 1 90° grease nipples
DGPA172	Display pack of 10 8m x 1 45° grease nipples
DGP185	Display pack of 10 ¼" UNF Str. grease nipples
DGPA187	Display pack of 10 ¼" UNF 45° grease nipples
DGPA188	Display pack of 10 ¼" UNF 67½° grease nipples
DGPA189	Display pack of 10 ¼" UNF 90° grease nipples
DGP200	Display pack of 10 10m x 1 Str. grease nipples
DGPA203	Display pack of 10 10m x 1 45° grease nipples
DGPA204	Display pack of 10 10m x 1 90° grease nipples

GREASE EQUIPMENT

Grease Nipple Thread Tester

MODEL DITI19809100



- Great tool box accessory to sort out mixed fittings
- Aluminium construction with mounting holes
- Designed to check the following threads:
 METRIC: M6x0.75, M8x1, M10x1, M6x1, M8x1.25, M10x1.5
 UNF/ANF: 1/4", 5/16", 3/8"
 BSW: 1/4", 5/16", 1/2"
 NPT: 1/8", 1/4", 3/8"
 BSPT: 1/8", 1/4"
 BSF: 3/16", 1/4", 5/16", 3/8"



Grease Nipples

Grease Nipple Assortment Kit

- MODEL DG4674 Agricultural Kit contains the following...

MODEL	Qty	Description	MODEL	Qty	Description	MODEL	Qty	Description
DG29	20	1/8" BSP Str.	DGA34	10	1/8" BSP 45°	DGA168	5	6m x 1 45°
DG185	20	1/4" UNF Str.	DGA187	10	1/4" UNF 45°	DG161	5	6m x 1 Str.
DG28	10	1/8" NPT Str.	DG162	5	8m x 1 Str.	DGA172	5	8m x 1 45°
DGA44	10	1/8" BSP 90°	DG1020	5	1/4" UNF 1 1/8" Long	DITI 1785701F	2	1/8" Std Duty 4 Jaw Coupler
DGA189	10	1/4" UNF 90°	DGA165	5	6m x 1 90°			



- MODEL DG4675 Imperial Kit contains the following...

MODEL	Qty	Description	MODEL	Qty	Description	MODEL	Qty	Description
DG29	18	1/8" BSP Str.	DGA37	6	1/8" NPT 67 1/2°	DGA20	6	5/16" BSF 67 1/2°
DG28	12	1/8" NPT Str.	DGA39	6	1/8" BSP 67 1/2°	DG114-U	6	1/4" UNF Str. LS
DG185	9	1/4" UNF Str.	DGA43	6	1/8" NPT 90°	DG48	4	1/4" BSP Str.
DGA44	6	1/8" BSP 90°	DG1	6	1/4" BSF Str.	DGA189	4	1/4" UNF 90°
DGA187	6	1/4" UNF 45°	DG12	6	5/16" BSF Str.			

- MODEL DG4676 Metric Kit contains the following...

MODEL	Qty	Description	MODEL	Qty	Description	MODEL	Qty	Description
DG161	20	6m x 1 Str.	DGA172	5	8m x 1 45°	DGA203	5	10m x 1 45°
DG162	20	8m x 1 Str.	DGA204	5	10m x 1 90°	DGA168	5	6m x 1 45°
DG200	10	10m x 1 Str.	DGA206	5	10m x 1.5 45°	DGA165	5	6m x 1 90°
DG205	10	10m x 1.5 Str.	DGA207	5	10m x 1.5 90°	DGA169	5	8m x 1 90°



- MODEL DG4679 Automotive Kit contains the following...

MODEL	Qty	Description	MODEL	Qty	Description	MODEL	Qty	Description
DG185	20	1/4" UNF Str.	DGA165	10	6m x 1 90°	DGA189	5	1/4" UNF 90°
DG161	20	6m x 1 Str.	DG48	10	1/4" BSP Str.	DG114-U	5	1/4" UNF Str. LS
DG29	10	1/8" BSP Str.	DGA187	10	1/4" UNF 45°	DGA44	5	1/8" BSP 90°
DGA168	10	6m x 1 45°	DGA39	5	1/8" BSP 67 1/2°	DGA34	5	1/8" BSP 45°

Grease Nipples Header Block

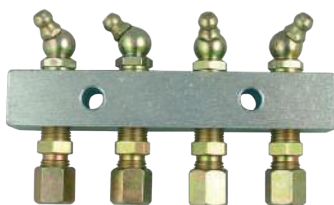

- Hard to reach bearings requiring lubrication can be connected to central points by tubing leading from the bearings to header blocks
- Blocks are equipped with 1/8" BSP x 6mm hose hydraulic fittings and are available for one, two, three, four, five, or six points
- Plated finish

MODEL	DGHB1	DGHB2	DGHB3	DGHB4	DGHB5	DGHB6
Description	1 Point	2 Point	3 Point	4 Point	5 Point	6 Point

WORKSHOP EQUIPMENT



WORKSHOP
EQUIPMENT



www.stm.net.au

www.stm.net.au



Table of Contents

Workshop Equipment

P91-100

Oil Drainers

- Oil Drainers
- Oil Changers
- Oil Drainer & Extractor Combo
- Low Level Oil Drainer
- Oil Extractor

P91-93

P91
P91
P92
P92
P93



Drum Trolleys

- Drum Truck Trolley
- Eze-Lift Drum Trolley
- Drum Trolleys
- Drum Dolleys
- Tilting Drum Trolley

P93-95

P93
P93
P94
P95
P95



Spill Containment Pallets

- Galvanized Steel Spill Containment Pallet
- Modular Spill Containment Pallet

P95-96

P95
P96



Drum Racks & Brake Bleeder

- Drum Racks
- Brake Bleeder

P96-97

P96-97
P97



Storage Tanks & Gantry System

- IBC Bund
- Double Skin Storage Tank
- Service Column 3 Wheel Gantry System

P98-99

P98
P99
P99



Workshop Accessories

- Extention Funnel
- Drum Lid
- Oil Drum Level Meter
- Drum Level Gauge

P100

P100
P100
P100
P100





Oil Drainers

Oil Drainer

- Suitable to drain waste oil by gravity from engines, gear boxes and differentials of all vehicles
- Valve fitted to collection bowl to allow inspection of drained oil before it enters reservoir
- Air operation for removal of oil from tank
- Part holding tray
- Collection bowl fitted with mesh tray
- Removal of extension funnel reduces minimum height by 100mm



Extension funnel
DITIEF10001



MODEL	DITIAOD3065E	DITIAOD3090E
Tank capacity	65 litre	90 litre
Collection bowl capacity	18 litre	18 litre
Collection bowl diameter	400mm	400mm
Draining hose length	2 metres	2 metres
Max draining pressure	14.5psi	14.5psi
Air inlet connection	¼" BSP	¼" BSP
Extension funnel diameter	DITIEF10001 - 606mm	DITIEF10001 - 606mm
Min height	1110mm	1250mm
Max height	1610mm	1950mm

Oil Drainer & Extractor Combo

- Combination 2-in-1 waste oil drainer and extractor
- Extracts oil using venturi-vacuum extracting system directly from dipstick hole
- Drain waste oil from engines, gear boxes and differentials of all vehicles
- Vacuum-charged unit is completely portable and easy to use
- Includes 6 suction probes (metal & flexible) equipped with quick-disconnect couplers for fluid extraction. Includes adaptors for BMW and Volkswagen
- Adjustable collection bowl height to work with jack lift or servicing hoist
- Collection bowl has valve to inspect drained oil
- Self-evacuating feature makes emptying clean and easy



MODEL	DITIAODE065E	DITIAODE090E
Tank capacity	65 litre	90 litre
Air pressure for vacuum	115psi	115psi
Suction rate	2 LPM	2 LPM
Drain / Suction hose length	2 metres	2 metres
Collection bowl capacity	18 litre	18 litre
Collection bowl diameter	400mm	400mm
Max draining pressure	14.5psi	14.5psi
Air inlet connection	¼" BSP	¼" BSP
Extension funnel diameter	DITIEF10001 - 606mm	DITIEF10001 - 606mm
Min height	1000mm	1100mm
Max height	1560mm	1800mm



Oil Drainers



Oil Changer

- Extract used oil and other fluids from any vehicle using this venturi-vacuum extracting system
- Great for cars, boats, motorcycles and small engines
- Vacuum-charged unit is completely portable and easy to use
- Includes 6 suction probes (metal & flexible) equipped with quick-disconnect couplers for fluid extraction. Includes adaptors for BMW and Volkswagen
- Self evacuating feature makes emptying clean and easy
- Can be used to check the quantity and quality of extracted oil immediately
- Part holding tray

MODEL	DITIAOE2065	DITIAOE2090
Tank capacity	65 litre	90 litre
Chamber capacity	8 litre	8 litre
Air pressure for vacuum	115psi	115psi
Suction rate	2 LPM	2 LPM
Suction hose length	2 metres	2 metres
Draining hose length	2 metres	2 metres
Max draining pressure	14.5psi	14.5psi
Air inlet connection	¼" BSP	¼" BSP



DITI1710002

Low level Oil Drainer

- Low-level oil drainer
- Suitable for collecting oil from engine, gear boxes and differentials of all vehicles
- Solid steel construction
- Solid swivel castors for easy movement
- Easy access to clearance outlet and suction hole provided on top
- Simply wheel under vehicle, avoids the need to carry waste oil containers around the workshop
- DITI16206561 - Equipped with 1:1 Air operated oil pump to quickly and easily remove waste oil from drainer



DITI16206561

MODEL	DITI1710002	DITI16206561
Capacity	68 litre	65 litre
Connection	¾" BSP	1:1 oil pump ½" BSP
Height	200mm	270mm
Length x width	1200mm x 625mm	800mm x 700mm
Handle length	860mm	850mm



Drum Trolleys



Oil Extractor

MODEL DITIAOE1090

- Air operated oil extractor using a venturi-vacuum extracting system
- Extract used oil and other fluids from any vehicle directly from dipstick hole
- Great for cars, boats, motorcycles and small engines
- Vacuum-charged unit is completely portable and easy to use
- Includes 6 suction probes (metal & flexible) equipped with quick-disconnect couplers for fluid extraction
- Adaptors for BMW and Volkswagen are also included
- Self evacuating feature makes emptying clean and easy
- ¼" BSP air inlet



Drum Truck Trolley

MODEL DIT119230000

- Easily move, tip, drain and store 205 litre drums
- Heavy loading capacity 150kgs
- Economy class
- With two 10" x2" wheel and two smaller 2" wheels
- Overall size: 59.8" x17.4" x24" / 1520x440x610mm
- Weight 25kgs



Drum Truck Trolley

MODEL DDH105

- 60 and 205 litre drum truck
- Heavy duty construction
- Specifically designed for lifting heavy drums
- Safety latch holds drum in place
- Easy movement with rubber tyre ball bearing wheels



Eze Lift Drum Trolley

MODEL DDH106

- 4T4-Eze lift trolley
- Trolley placed around drum and fixes to top of drum, with push off handle drum locks in place
- Approved by Department of Labour and Industry
- Easy action eliminates back injury
- Strong construction and durable finish



Drum Trolleys

Drum Trolley

- Sturdy drum trolley
- Makes moving oil and grease drums easier
- Suitable for different shapes of drums
- 2 high quality wheels and castors respectively
- DD41111 - Pneumatic front tyres with rear swivel wheel and locking brake
- DD41111 - Chain to secure drum and anti-tilt feet fitted to trolley



DIT11708002



DIT11708003



CA972



DIT11708001



DD41111

MODEL	CA972	DIT11708001	DIT11708002	DIT11708003	DD41111
Holding capacity	20-60 litre / 20-60 kg	20-60 litre / 20-60 kg	205 litre / 180 kg	205 litre / 180 kg	205 litre / 180 kg
Drum diameter	385mm	385mm	600mm	600mm	600mm
Hose reel compatible	-	-	-	Yes	Yes
Construction	Steel, zinc plated	Steel, zinc plated	Steel, zinc plated	Steel, zinc plated	Steel, painted
Weight	2kg	7kg	17kg	35kg	25kg



Drum Trolleys/Spill Containment

Drum Dolly

- Makes moving drums easier
- Fitted with quality castors to facilitate easy movement
- Gives mobility to filled drums and converts empty drums to mobile containers
- Welds ground smooth for snag free performance



DITISC0509



DITISC0506

MODEL	DITISC0509	DITISC0506
Drum capacity	20 litre	205 litre

Tilting Drum Trolley

MODEL DDH104

- 205 litre tilting drum stand
- Enables drum to be loaded and transported easily by one person
- Handles retract when drum placed in horizontal position
- Plastic grips on handles prevent slipping when drum being loaded or moved



Spill Containment Pallet

- Holding tank capacity 210 litres (2 Drum), 200 litres (4 Drum)
- Zinc plated steel grate
- Fork lift leg raisers
- 2 Drum 825mm x 1250mm x 345mm (500 kg loading capacity)
- 4 Drum 1330mm x 1330mm x 240mm (1000 kg loading capacity)



DIT116222091, DIT116222093



Spill Containment

Modular Spill Containment Pallet

MODEL DITI1788001

- Strong and durable polyethylene construction
- Easily connect multiple drum pallets to make a customised drum storage platform, 4 drum, 6 drum etc.
- Lightweight for easy transportation and positioning
- Each unit is supplied with 1 x Triangle (DT0004) & 1 x Tetrapod (DT0003) modular cover to contain fluids between pallets when connecting 2 or more containment pallets together



DK1018



2 x DK1018 end-to-end

2 x DK1018 side-by-side

Modular Covers

DT0003

DT0004

MODEL	DD61312	DD61324	DK1018
Drum capacity	2 drum	4 drum	2 drum
Holding tank capacity	210 litres	270 litres	220 litres
Loading capacity	500 kg	1000 kg	1000 kg
Modular	-	-	Yes
Construction base	Zinc coated, Steel	Zinc coated, Steel	Polyethylene
Construction grate	Galvanized steel	Galvanized steel	Polyethylene
Dimensions (l x w x h)	1200mm x 800mm x 200mm	1325mm x 1325mm x 245mm	1320mm x 670mm x 420mm

205L Drum Rack

MODEL DITI19801100

- 2 Drum rack
- Fork lift entry from all sides and can be safely stacked 4 units high
- Loading capacity 727kg
- Aluminium construction
- Overall size: 45.6" x 30.3" x 12.5" / 1160x770x320mm
- Weight 23kgs





Drum Racks & Brake Bleeder

205 Litre Drum Rack

- 205 litre drum stacking racks
- Easily stacked – accommodating fork lift entry
- May be stacked up to 4 tiers high
- All welded heavy gauge tubular and structural steel construction with 3" channel crossbeams



DDH107



DDH108

MODEL	DDH107	DDH108
Drum	2 drum	3 drum
Holding tank capacity	205 litres	205 litres

Brake Bleeder

MODEL DIT1788001



- Air operated bleeding device for hydraulic brakes and clutches of all motor vehicles
- Six types of plugs equipped to suit Audi, BMW, Citron, Ford, Jaguar, Mercedes Benz, Peugeot, Porche, Renault, Saab, Volkswagen, Volvo
- Reserve air tank enables constant pressure for several bleeding operations without further recharges
- Convenient, easy to operate and safe
- 1 funnels, 2 bottles with connecting hose and 3 metres of hose
- Tool tray and carry handle
- For ABS set at 1 bar maximum

MODEL	DIT1788001
Fluid reservoir capacity (upper chamber)	6 litre
Reservoir air tank (low chamber)	7 litre
Max working pressure (middle chamber)	30psi
Max pressure reserve reservoir (low chamber)	145psi
Delivery hose length	3 metres
Safety valve	145psi
Air inlet connection	¼" BSP



IBC Bund



IBC Bund

MODEL DOT7588

- Bund from glass fibre reinforced plastic and galvanized steel grating for IBC container
- The practical storage and filling station for water-polluting and inflammable liquids with a flash point >55°C and general construction inspection approval
- Universal applicable for waste oil, solvents and acids
- 100% corrosion-resistant
- Can holder not included
- IBC Tank not included
- Base pallet (Model DOT7591) shown is not included, however can be ordered as a separate component



Base Pallet
DOT7591

MODEL	DOT7588
Volume capacity	1000 litre
Loading capacity	1600 kg
Weight of bund	93 kg
Dimension of bund (l x w x h)	1620mm x 1190mm x 910mm
Base pallet ground clearance (DOT7591)	90mm
Base pallet ground weight (DOT7591)	25 kg

IBC Bund (PE) with Perforated Plate

MODEL DOT8582

- Manufactured from high quality polyethylene
- High resistance to chemicals
- 1100 Litre capacity
- Loading capacity 2000Kg
- Weight 105Kg
- External dimensions 145cm x 145cm x 100cm
- Forklift accessible





Storage Tank & Gantry System

Double Skin Storage Tank



DOT7380

- Inner tank made of HDPE
- Outer tank zinc coated steel sheet
- Suitable for clean and waste oils
- Filling level indicator
- Visual leakage indicator
- Integrated carry handles
- No bunding required
- For clean or waste oils

MODEL	DOT7979	DOT7379	DOT7380	DOT7881
Tank capacity	400 litre	750 litre	1000 litre	1500 litre
Dimensions (L x W x H)	730mm x 700mm x 117mm	980mm x 770mm x 1420mm	1280mm x 770mm x 1420mm	1630mm x 770mm x 1850mm
Weight	50 kg	66 kg	89 kg	151 kg

Service Column 3 Reel Gantry

MODEL DITI29992009

- The gantry can hold up to 3 hose reels including the: (860 Series or 2950 Series)
- The maximum number of drip trays that can be mounted on the gantry are 3 pieces, which are optional
- One oil pump can also be mounted to the gantry
- Unit provides adequate space for oil drums under the hose reels
- Eliminates the expense of installing piping systems
- Size: 70"Wx"39"Dx93"L (1770x1000x2370mm)
- Does not include air operated pump, hose reels, drip trays or oil control guns

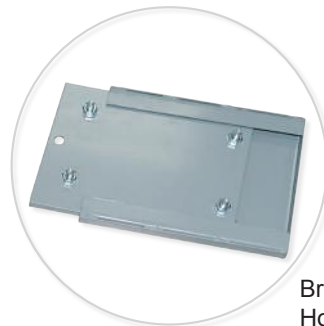

Bracket used to support
Hose Reels



Workshop Accessories

Oil Drainer Extension Funnel

MODEL DITIEF10001



- Extension funnel for waste oil drainer & changer collection bowls
- Funnel diameter 600mm
- Makes it easier to position and capture fluid from engine crankcases, gearboxes, etc.
- To suit 400mm diameter collection bowls on drainers

Drum Lid

MODEL DDH109



- Drum pal – protective drum lid
- Reusable drum lid, allows storage of drums outside and prevents damage caused by rust, dirt and moisture
- Excellent resistance to most chemicals and acids
- Innumerable reuses so that each use amounts to cents in cost

Oil Drum Lever Meter

MODEL DG116308



- Suitable for 205 litre drums
- Fits standard 3/4" bung opening
- Allows for simple stock-keeping
- Can be personalised - telephone number and logo can be put onto meters' face
- Protection against loss as each tapping will become immediately visible
- Longevity and robustness - resistant against oils and benzine
- Ease of installation - it can always be reused

Drum Level Gauge

MODEL DITI19800701



- Suitable for 205 litre drums
- Fits standard 3/4" and 2" bung openings
- Allows for simple stock-keeping
- Ease of installation and can be reused
- Strong durable made from polypropylene and ABS with a Kevlar line

ANCILLARY EQUIPMENT



www.stm.net.au

ANCILLARY
EQUIPMENT



Table of Contents

Ancillary Equipment

P103-115

Replacment Parts

- Spouts
- ATF Filter
- Nozzles

P103-104

- P103
- P103
- P103-104



Air Regulators & Lubricators

- Air Regulator / Lubricator
- Air Regulator
- Air Filter / Regulator
- Lubricator

P104-105

- P104
- P104
- P104
- P105



Adaptors, Hose Kits & Oil Jugs

- Taps
- Adaptors
- Hose Kits
- Diesel Hose
- Drum Spanner
- Oil Jugs & Bottles
- PVC Hose & Hose Clamps
- Suction Pipe

P105-110, 117

- P105-106
- P106-107
- P108
- P108
- P109
- P110
- P117
- P117



Farm Tank Equipment

- Water Nozzles
- Filters / Gate Valve
- Hose Tail & Nipple
- Elbows

P111-113

- P111
- P111
- P112
- P113



Valves

- Full Boare Ball Valve
- Gate Valve Taps
- Gate Valve

P113-114

- P113
- P113
- P114



Camlock Fittings

- Camlock Couplings
- Camlock Dust Plugs
- Camlock Adaptors

P114-116

- P114-115
- P116
- P116





Replacement Parts



Anti-drip Spout

MODEL CB261

- Anti drip spout
- Fits 12mm hose only
- For pumps CA465, CA467



ATF Anti-drip Spout

MODEL CB262

- Anti drip spout, filter and 12mm hose connector
- For pumps CA465 ATF, CA467 ATF



ATF Filter

MODEL CB271

- Automatic transmission fluid filter – Supplied as replacement item
- For Pumps CA465ATF, CA467ATF, CA480ATF, CA469ATF, CA490ATF



ATF Lever Nozzle

MODEL CB272ATF

- Lever operated nozzle supplied with automatic transmission fluid filter and 16mm hose connector
- For Pump CA480ATF, CA469ATF



Air Regulators & Lubricators

Lever Nozzle

MODEL CB272



- Lever operated nozzle supplied with 16mm hose connector
- For Pump: CA480G, CA469G

Air Filter / Regulator / Lubricator

MODEL DITIBC2000



- Air filter, regulator, gauge and lubricator
- For use with air operated pumps
- Complete kit
- Lubricator ensures air motor operates at premium efficiency
- Recommended for use with all air operated pumps
- 1/4" BSP threads
- Safety protective metal casing

Air Regulator

MODEL DITIBR2000



- Air regulator and gauge
- Regulates the air flow into the pump
- Gauge gives accurate read out of air flow into the pump
- 1/4" BSP threads

Air Filter / Regulator

MODEL DITIBFR2000



- Air regulator filter
- Regulates and filters the air flow into the pump
- Gauge gives accurate read out of air flow into the pump
- 1/4" BSP threads
- Safety protective metal casing



Lubricator

MODEL DITIBL2000

- Lubricator ensures air motor operates at premium efficiency
- Easy adjustment of oil drip
- 1/4" BSP threads
- Safety protective metal casing



Metal Drum Tap

MODEL DJL5314

- 3/4" (20mm) self closing drum faucet
- Strong metal construction
- Nylon valve head to suit petroleum products
- Can be locked with padlock



Drum Tap for Heavy Fluids

MODEL DJL5319

- Great for dispersing high volumes of oil and other heavy fluids directly from the drum
- Cast iron body & brass faceplate and spring for perfect seal
- 2" thread (50mm thread)
- Can be locked with padlock



Heavy Duty Water Tap

MODEL DJL3111

- Water dispensing tap, fill radiators, windshield washer fluid etc
- 1/2" BSP thread



Adaptors



Plastic Tap

MODEL DB201

- 2" BSP lever plastic tap



205lt Plastic Adaptor

MODEL DB204

- 2" BSP Mauser Adaptor (56mm x 4mm)
- For plastic 205 litre drums
- Suitable for UREA/DEF
- Colour: White



Plastic Adaptors

- 205 Litre drum thread adaptors
- Used where threads need to be converted to a 2 inch BSP thread to facilitate the use of different pumps and taps
- Various sizes available

MODELS	SPECIFICATIONS
DJL3401	2"BSP Female to 2" Male TRISURE
DJL3402	2"BSP Female to 2" Male MAUSER
DJL3403	2"BSP Female to DIN 61 Female
DJL3404	2"BSP Female to 59mm Female TOURNEX
DJL3405	2"BSP Female to DIN 51 Female
DJL3406	2"BSP Female to 63mm Female
DJL3407	2"BSP Female to DIN 71 Female
DJL3408	G2" AUF Female to S64 x 4 Male
DJL3409	G2" AUF Female to S70 x 6 Male with Viton Seal



Adaptors



IBC Adaptors

- Connect 1" and 2" hoses to an IBC container with 60mm outlet
- The "nut" turns without the shank turning
- Shutz thread.

MODEL	SPECIFICATIONS
DJL3410	IBC Adaptor 60mm Female x 6 to 1" Barb Tail
DJL3412	IBC Adaptor 60mm Female x 6 to 2" Barb Tail



Adaptors with Locking Screw

- Enables movement of pipe or hose in drum or container before being locked tight
- Measurements for the internal diameter are taken when the adapter is locked (closed). For example the DJL3421-1 has an internal diameter of 36mm when locked. Before it is locked the internal diameter is 37mm.

MODEL	SPECIFICATIONS
DJL3421-1	2" Male & ID 1&1/2" (36MM) with Locking Screw
DJL3421-2	2" Male & ID 1.57" (40MM) with Locking Screw



IBC Mauser Adaptor

MODEL DJ3402

- 2" BSP to 2" Mauser thread



Pump Suction Extension Adaptor

MODEL DR70011940AD

- Pump suction extension adaptor
- Suitable for DR70011940 oil pump
- O.D - M26 x 1.5
- I.D - M30 x 1



Hose Kits



12mm Hose Kit

MODEL CB465H

- 20 Litre oil pump hose
- 1.5 metres of clear PVC hose 12mm hose
- Comes reinforced with internal spring
- Hose clips provided

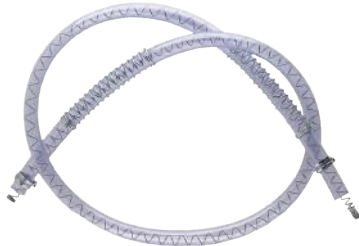

16mm Hose Kit

MODEL CB469H

- 60 Litre pump hose
- 1.5 metres of clear PVC 16mm hose
- Comes reinforced with internal springs
- Hose clips provided



Fuel Resistant Hose Kit

MODEL DA01JW214H

- Rotary pump hose – fuel resistant
- 2 metres of zero temperature hose 25mm I.D.
- Rigid metal spout
- Hose clips provided
- Suitable for DA01JW214 & DA02LP32



25mm Diesel Hose

MODEL DHZ25

- Zero temperature farm hose
- Australian made fuel hose
- Black PVC - abrasion, weather and ozone resistant
- Suitable for petrol, oil, kerosene, and diesel
- Available in 20 meter rolls
- 25mm I.D.



Drum Spanners



Hose Nozzle

MODEL DJIS1

- Spout suitable for diesel and unleaded petrol
- Aluminium construction
- Can be used with 1" I.D. hose
- Suitable for hand pumps



Drum Spanner

MODEL DB31

- Drum spanner
- Suits 2" & ¾" drum fittings
- Provides easy drum opening
- Moulded from engineering plastic resin



Diecast Drum Spanner

MODEL DJL4021

- Fits most metal and plastic 205 litre drums
- Opens both 2" (50mm) and ¾" (20mm) bungs
- Easy Action
- Strong diecast construction, will not break or chip



Multi Purpose Drum Spanner

MODEL DJL40211

- Fits all metal and plastic 205 litre drums
- Opens both 2" (50mm) and ¾" (20mm) bungs
- Easy Action
- Strong metal construction



Oil Jugs



Oil Jug

- Plastic measuring jug
- Comes with protection lid and flexible outlet
- Made from high class polypropylene
- White in colour
- Calibration gauge in litre and quarts

MODEL	DAM3320027	DAM3320058
Litre	2 litre	5 litre



Oil Bottle

MODEL DB100

- 1 Litre plastic oil bottle
- Verified Oil Bottles for driveway use
- Made from non-breakable, ultra violet and impact resistant material
- Comes with pourer and cap
- Calibration gauge in ml showing 250, 500, 750 and 1000



Fuel



Oil



UREA/DEF



Grease





Farm Tank Equipment



Long Spout Water Nozzle

MODEL DKSKW9151L

- Water nozzle with 7.5mm diameter outlet for concentrated pressure
- Solid diecast construction
- Brass swivel
- 1" BSP female inlet
- Ideal for concrete trucks or for wash down applications
- Also available Short Spout Water Nozzle - DKSKW9151S



Short Spout Water Nozzle

MODEL DMAJ50AS

- Water nozzle with 7.5mm diameter outlet for concentrated pressure
- Solid diecast construction
- 1" BSP female inlet
- Ideal for concrete trucks or for wash down applications



Filter / Gate Valve Unit

MODEL DS102V

- Combination filter and gate valve unit
- Comes with removable brass mesh filter cartridge
- 1" BSP threaded inlet
- 1" barbed outlet



Air Vent

MODEL DS105

- Air vent
- Aluminium construction and fitted with brass mesh filter
- 1" BSP threaded inlet
- Suits most fuel tanks



Farm Tank Equipment



Locking Cap

MODEL DS109

- Locking cap
- 2" aluminium locking cap



Line Filter

MODEL DS104

- Line filter
- 25mm 'Y' type line filter
- Removable brass gauze filter
- 1" BSP thread



Hose Tail

MODEL DBN2525

- 25mm hose tail
- Diecast hose tail
- 1" BSP thread



Nipple

MODEL DBN25

- Hex nipple
- 25mm galvanised hex nipple
- 1" BSP thread



Elbows



MODEL	Inlet	Outlet
DBE2020MF	3/4" male	3/4" female
DBE2525MF	1" male	1" female
DBE2020F	3/4" female	3/4" female
DBE2525F	1" female	1" female

Full Bore Ball Valves

- Full bore ball valves
- Standard BSP threads

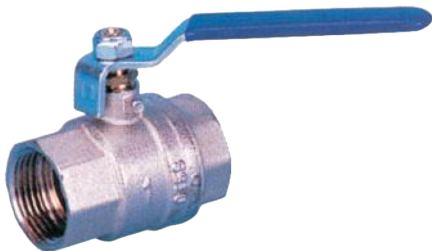

MODEL	DESCRIPTION
ST15-225FBG	1/2"
ST20-225FBG	3/4"
ST25-225FBG	1"
ST32-225FBG	1 1/4"
ST40-225FBG	1 1/2"
ST50-225FBG	2"
ST65-225FBG	2 1/2"
ST80-225FBG	3"
ST100-225FBG	4"

Gate Valve Taps

- Brass ball valve comes with tap hose end
- Standard BSP threads



MODEL	DESCRIPTION
ST15-132	1/2"
ST20-132	3/4"
ST25-132	1"



Valves & Camlock Fittings



Gate Valve

- Brass gate valves
- Standard BSP threads

MODEL	DESCRIPTION
ST15-221	½"
ST20-221	¾"
ST25-221	1"
ST32-221	1¼"
ST40-221	1½"
ST50-221	2"
ST65-221	2½"
ST80-221	3"
ST100-221	4"



Camlock Coupling A

- Aluminium camlock adaptor to BSP Female

MODEL	DESCRIPTION
STPC20-A-AL	¾"
STPC25-A-AL	1"
STPC32-A-AL	1¼"
STPC40-A-AL	1½"
STPC50-A-AL	2"
STPC65-A-AL	2½"
STPC80-A-AL	3"
STPC100-A-AL	4"
STPC150-A-AL	6"

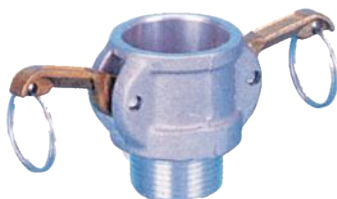

Camlock Coupling B

- Aluminium camlock coupling to BSP male

MODEL	DESCRIPTION
STPC20-B-AL	¾"
STPC25-B-AL	1"
STPC32-B-AL	1¼"
STPC40-B-AL	1½"
STPC50-B-AL	2"
STPC65-B-AL	2½"
STPC80-B-AL	3"
STPC100-B-AL	4"



Camlock Fittings

Camlock Coupling C

- Aluminium camlock coupling to hose tail

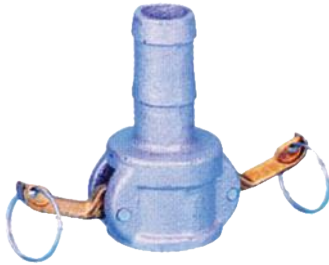

MODEL	DESCRIPTION
STPC20-C-AL	¾"
STPC25-C-AL	1"
STPC32-C-AL	1¼"
STPC40-C-AL	1½"
STPC50-C-AL	2"
STPC65-C-AL	2½"
STPC80-C-AL	3"
STPC100-C-AL	4"
STPC150-C-AL	6"

Camlock Coupling D

- Aluminium camlock coupling to BSP Female

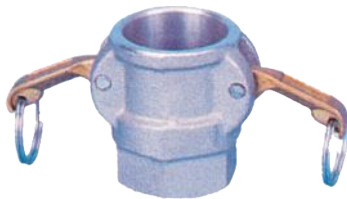

MODEL	DESCRIPTION
STPC20-D-AL	¾"
STPC25-D-AL	1"
STPC32-D-AL	1¼"
STPC40-D-AL	1½"
STPC50-D-AL	2"
STPC65-D-AL	2½"
STPC80-D-AL	3"
STPC100-D-AL	4"
STPC150-D-AL	6"

Camlock Coupling DC

- Aluminium camlock dust cap



MODEL	DESCRIPTION
STPC20-DC-AL	¾"
STPC25-DC-AL	1"
STPC32-DC-AL	1¼"
STPC40-DC-AL	1½"
STPC50-DC-AL	2"
STPC65-DC-AL	2½"
STPC80-DC-AL	3"
STPC100-DC-AL	4"
STPC150-DC-AL	6"



Camlock Fittings

Camlock Dust Plug DP

- Aluminium camlock dust plug



MODEL	DESCRIPTION
STPC20-DP-AL	¾"
STPC25-DP-AL	1"
STPC32-DP-AL	1¼"
STPC40-DP-AL	1½"
STPC50-DP-AL	2"
STPC65-DP-AL	2½"
STPC80-DP-AL	3"
STPC100-DP-AL	4"
STPC150-DP-AL	6"

Camlock Adaptor Hose Tail E

- Aluminium camlock adaptor to hose tail



MODEL	DESCRIPTION
STPC20-E-AL	¾"
STPC25-E-AL	1"
STPC32-E-AL	1¼"
STPC40-E-AL	1½"
STPC50-E-AL	2"
STPC65-E-AL	2½"
STPC80-E-AL	3"
STPC100-E-AL	4"
STPC150-E-AL	6"

Camlock Adaptor F

- Aluminium camlock adaptor to BSP male



MODEL	DESCRIPTION
STPC20-F-AL	¾"
STPC25-F-AL	1"
STPC32-F-AL	1¼"
STPC40-F-AL	1½"
STPC50-F-AL	2"
STPC65-F-AL	2½"
STPC80-F-AL	3"
STPC100-F-AL	4"
STPC150-F-AL	6"



PVC Hose & Hose Clamps

PVC Hose

- Reinforced transparent PVC hose
- Where application requires longer hose between suction tube and pump



MODEL	Hose I.D
DITIPVC19	ø19mm
DITIPVC25	ø25mm
DITIPVC32	ø32mm



Suction Pipe

MODEL CB285-6

- P.V.C. Inlet pipe fittings for use with air operated transfer pump
- Faucet socket 1" BSP suction pipe 25mm

Hose Clamps

- Clamps made from zinc plated mild steel (Stainless steel also available Contact STM)



MODEL	ADJUSTMENT (mm)	INCHES	SIZE NO
YS295-012	9.5 - 12	3/8 - 1/2	000
YS295-016	11 - 16	1/2 - 5/8	M00
YS295-020	13 - 20	1/2 - 3/4	00
YS295-022	16 - 22	5/8 - 7/8	0
YS295-025	18 - 25	3/4 - 1	OX
YS295-030	22 - 30	7/8 - 1 1/8	1A
YS295-035	25 - 35	1 - 1 1/8	1
YS295-040	30 - 40	1 1/8 - 1 1/2	1X
YS295-050	35 - 50	1 1/4 - 1 3/4	2A
YS295-055	40 - 55	1 1/2 - 2 1/8	2
YS295-060	45 - 60	1 3/4 - 2 3/8	2X
YS295-070	55 - 70	2 - 2 3/4	3



Notes

STM Australia Pty Ltd

Notes



Appendix

Conversion Factors

FROM	TO	MULTIPLY BY
MASS		
Ounce	Gram (g)	28.349
Gram (g)	Ounce (oz)	0.035
Pound (lb)	Kilogram (kg)	0.454
Ton	Tonne	1.016
Tonne	Ton	0.984
DENSITY		
Pound/cubic inch (lb/in ³)	Gram/cubic centimeter (g/cm ³)	27.679
Gram/cubic centimeter (g/cm ³)	Pound/cubic inch (lb/in ³)	0.036
Pound/cubic foot (lb/ft ³)	Kilogram/cubic metre (kg/cm ³)	16.018
Kilogram/cubic metre (kg/m ³)	Pound/cubic foot (lb/ft ³)	0.062
Pound/cubic yard (lb/yd ³)	Kilogram/cubic metre (kg/m ³)	0.593
Kilogram/cubic metre (kg/m ³)	Pound/cubic yard (lb/yd ³)	1.685
PRESSURE		
Pound/foot (lb/ft)	Kilogram/metre (kg/m)	1.4882
Kilogram/metre (kg/m)	Pound/foot (lb/ft)	0.672
Pound/square inch (lb/in ²)	Kilogram/square centimeter (kg/cm ²)	0.07031
Kilogram/square centimeter (kgf/cm ²)	Pound/square inch (bf/in ²)	14.22
Pound/square inch (lbf/in ²)	Kilopascal (kPa ²)	6.895
Kilopascal (kPa)	Pound/square inch (lbf/in ²)	0.145
Pound/square inch (lbf/in ²)	Megapascal (mPa ²)	0.006895
Megapascal (mPa)	Pound/square inch (lbf/in ²)	145.04
Ton/square inch (tonf/in ²)	Megapascal (mPa)	15.444
Megapascal (mPa)	Ton/Square inch (tonf/in ²)	0.0647
Bar	Kilogram/square centimeter (kgf/cm ²)	1.02
Kilogram/square centimeter (kgf/cm ²)	Bar	0.981
Bar	Pound/square inch (lbf/in ²)	14.503
Pound/square inch (lbf/in ²)	Bar	0.0689
Bar	Kilopascal (kPa)	100
Kilopascal (kPa)	Bar	0.01
TEMPERATURE		
Fahrenheit (F)	Centigrade (C)	(Cx1.8)+32
Centigrade (C)	Fahrenheit (F)	(f-32)/1.8
LENGTH		
Thou. inch (uin)	Millimetre (mm)	0.0254
Millimetre (mm)	Thou. inch (uin)	0.0394
Inch (in)	Centimeter (cm)	2.54
Centimeter (cm)	Inch (in)	0.3937
Foot (ft)	Metre (mtr)	0.3048
Metre (mtr)	Foot (ft)	3.2808
Mile	Kilometre (km)	1.609
Kilometre (km)	Mile	0.6214
VOLUME		
Cubic inches (ci)	Cubic centimetres (cc)	16.3871
Cubic centimetres (cc)	Cubic inches (ci)	0.061
Cubic foot/min (cfm)	Litre/min (l/min)	28.3168
Litre/min (l/min)	Cubic foot/min (cfm)	0.0353
Cubic yard (yd ³)	Cubic metre (m ³)	0.7646
Cubic metre (m ³)	Cubic yard (yd ³)	1.3079
Liquid ounce (fl oz)	Cubic centimetre (cm ³)	28.4131
Cubic centimetre (cm ³)	Liquid ounce (fl oz)	0.035
Pint	Litre	0.5682
Litre	Pint	1.759
Imperial gallon	Litre	4.546
Litre	Imperial gallon	0.2197



Appendix

Conversion Tables

IMPERIAL TO METRIC

INCHES FRACTION	INCHES DECIMAL	MM	INCHES FRACTION	INCHES DECIMAL	MM
1/64	0.016	0.397	33/64	0.516	13.097
1/32	0.031	0.794	17/32	0.531	13.494
3/64	0.047	1.191	35/64	0.547	13.891
1/16	0.063	1.588	9/16	0.563	14.288
5/64	0.078	1.984	37/64	0.578	14.684
3/32	0.094	2.381	19/32	0.594	15.081
7/64	0.109	2.778	39/64	0.609	15.478
1/8	0.125	3.175	5/8	0.625	15.875
9/64	0.141	3.572	41/64	0.641	16.272
5/32	0.156	3.969	21/32	0.656	16.669
11/64	0.172	4.366	43/64	0.672	17.066
3/16	0.188	4.763	11/16	0.688	17.463
13/64	0.203	5.159	45/64	0.703	17.859
7/32	0.219	5.556	23/32	0.719	18.256
15/64	0.234	5.953	47/64	0.734	18.653
1/4	0.250	6.350	3/4	0.750	19.050
17/64	0.266	6.747	49/64	0.766	19.447
9/32	0.281	7.144	25/32	0.781	19.844
19/64	0.297	7.541	51/64	0.797	20.241
5/16	0.313	7.938	13/16	0.813	20.638
21/64	0.328	8.334	53/64	0.828	21.034
11/32	0.344	8.731	27/32	0.844	21.431
23/64	0.359	9.128	55/64	0.859	21.828
3/8	0.375	9.525	7/8	0.875	22.225
25/64	0.391	9.922	57/64	0.891	22.622
13/32	0.406	10.319	29/32	0.906	23.019

PRESSURE

PSI	kPa	kPa	PSI
1	6.9	1	0.15
2	13.8	2	0.29
3	20.7	3	0.44
4	27.6	4	0.58
5	34.5	5	0.73
6	41.4	6	0.87
7	48.3	7	1.02
8	55.2	8	1.16
9	62.1	9	1.31
10	69.0	10	1.45
50	345	50	7
100	690	100	15
250	1724	250	36
500	3447	500	73
1000	6895	1000	145
5000	34470	5000	725
10000	68950	10000	1450
20000	137900	20000	2901
50000	344700	50000	7252
75000	517100	75000	10880
100000	689500	100000	14500

Display Stands



- Stand out from the crowd and showcase STM products using our very own dedication STM branded display stand
- Pre-designed package offering our most sought after products
- Items can be changed to suit your needs

Model	Description	Qty
Hand Pumps		
DO51370	Oil can with rigid spout	1
CA586	1 litre tom thumb oil pump	4
CA465G2	20 litre gear oil pump	3
DA01JW214	205 litre rotary pump	2
DA491	205 litre lever oil pump	1
DJPP200LP	205 litre plastic multi purpose pump	2
DA02LP32	205 litre high flow rotary pump	1
Grease Equipment		
DKCG-500	450 Gram lever operated gun	2
DKCG-481N	450 Gram pistol grip grease gun	1
DKCG-483N	High pressure pistol grip grease gun	1
DKCH12	Hose 12" nylon with coupler	3
DKCH18	Hose 18" nylon with coupler	3
DGPA172	Display pack of 10 8m x 1 45° grease nipples	3
DGP161	Display pack of 10 6m x 1 Str. grease nipples	3
Fuel Transfer Equipment		
DIT11581400	Diesel flow meter	1
DKSK9151A	Manual diesel nozzle	2
DBNS10	Fuel filter	1
DBNS20	Filter element	1

Marketing Material



- STM can provide you with marketing support to help generate brand awareness to get customers into your store.
- The STM brand has been well recognized for over 60 years and is still promoted constantly through local & national newspapers, trade magazines, radio advertising and online marketing.

Marketing Material on Offer..

- ▶ Flyers - to give to your customers (can also be branded with your colours)
- ▶ Stickers
- ▶ Outdoor and indoor signs
- ▶ Pocket brochure
- ▶ STM Merchandise - counter mats, pens, note pads and more
- ▶ Online STM website for in-depth product information & support
- ▶ Web banners, Images & content to load onto your own website



Marketing Support

Online Webstore

Easy Online Ordering

- Our goal is to provide great customer service, so we have set-up a customer focused, interactive webstore.
- Simply & easily find the product you are after and learn everything you need to know about that product to make the right purchasing decision
- We have set-up each account customer with online access where you can view buy and sell prices, get instant quotes, order online quickly and easily without having to pick up the phone and have access to our online special deals 24/7

Features

- ▶ Browse our entire range of products
- ▶ Place orders
- ▶ View & re-order past orders
- ▶ Check stock availability
- ▶ View buy price and recommended selling prices
- ▶ Receive online special
- ▶ and more..

• Webstore only available to approved account customer

The screenshot shows the STM Australia Pty. Ltd. website interface. At the top, there is a navigation bar with categories: HOME, HAND PUMPS, OIL TRANSFER EQUIPMENT, FUEL TRANSFER EQUIPMENT, UREA/DEF EQUIPMENT, GREASE EQUIPMENT, WORKSHOP EQUIPMENT, ANCILLARY EQUIPMENT, CLEARANCE ITEMS, and SALES. A search bar is located in the center, and a shopping cart icon shows 'Cart (1) AU\$ 10.00'. Below the navigation bar, there is a large banner for 'Lubrication Dispensing Equipment Specialist' featuring a close-up of a gear pump. To the right of the banner are three promotional boxes: 'Tooling Equipment', 'STM NEWS', and a 'SALE' sign. Below the banner, there are three featured articles from November 2014: 'Featured Article: The Beginning of the STM News Channel', 'Featured Product: No.1 20Lt Gear Oil Pump - CA465G2', and 'Website Launch: www.stm.net.au Launch'. At the bottom, there is a row of six product listings with images and prices: 20 Litre Gear Oil Pump (AU\$22.50), 1 Litre Tom Thumb Oil... (AU\$10.90), 205 Litre Heavy Duty ... (AU\$58.00), Smart 4-In-1 Grease ... (AU\$46.00), 450 Gram Lever Oper... (AU\$19.40), and 450 Gram Heavy Duty... (AU\$42.00).



Application for Credit Account

STM Australia Pty Ltd

ACN 004 301 722

ABN 32 004 301 722

Business / Company: _____
 Proprietor(s) / Directors: _____
 Postal Address: _____
 Delivery Address: _____
 Phone Number: _____ Fax Number: _____
 Email Address: _____ Cust Number: _____
 Sales Email: _____
 Website Address: _____

Type of Industry (Tick one of the boxes below):

Industrial Automotive Agricultural Fuel & Oil Other (Please Specify): _____

Commencement date under above name and ownership _____

If new business or recent name change, comment on background of partners / directors.

BUSINESS REFERENCES

1. _____ Phone No: _____
 Fax: _____
 Phone No: _____
 2. _____ Fax: _____
 Phone No: _____
 3. _____ Fax: _____

BANK DETAILS (Branch Name & Address)

CREDIT AMOUNT LIMIT: \$ _____ AMOUNT PER MONTH: \$ _____

DATE: ____/____/____ ABN No. (GST) _____

I / We the under signed accept STM Australia Pty Ltd standard terms of credit which will be:

1. Payment Strictly Net 30 Days End of Month.
2. Freight F.O.B.
3. I / We agree that the title of ALL the goods supplied to our company does not pass until payment for ALL the goods including GST is paid in full.

TITLE: _____ SIGNED: _____

INTERNAL OFFICE USE ONLY

Approved By _____

() Tooling Account () Pump Account

APPROVED / DECLINED DATE ADVISED ____/____

FAX COMPLETED FORM TO (03) 9885 9366

FAX COMPLETED FORM TO (03) 9885 9366

Perforated



Terms & Conditions

Warranty

STM Australia offers a minimum 12 month warranty to all products from date of purchase. The warranty applies to faulty material and workmanship. It does not apply to damage caused either accidentally or deliberately to the goods.

Return of Goods

STM Australia will not accept the return of any goods without a member of our staff being notified and approval given for the items to be returned. All goods returned will be at the expense of the sender unless otherwise instructed by a STM Australia staff member. STM Australia will not accept any freight charges for goods returned unless authorized. If goods are returned for any reason other than a warranty claim a handling fee may be charged.

Freight

Freight is F.O.B. All goods will be dispatched by STM Australia via our preferred freight company unless otherwise advised. The goods will generally be sent via road transport, subject to the size of the goods. Stock will be dispatched from our Melbourne, Perth, Brisbane or Auckland warehouses. STM Australia will always endeavour to keep freight charges to a minimum.

Goods Dispatch

STM Australia will endeavour to dispatch all orders received before midday on the same day. Orders received after midday will be dispatched the following working day. If any goods are out of stock at the time of dispatch they will be placed on backorder and you will be contacted to make alternative arrangements.

Product Specifications

STM Australia reserves the right to alter product specifications or withdraw products at any time without prior notice. Due to the printing process, colours may vary slightly to the actual item.



For All Enquiries Call: 1300 131 531

Fax: 1300 308 508

www.stm.net.au

Email: enquiries@stm.net.au

*your call will be directed to your nearest
customer representative*

Head Office

1/615 Warrigal Road
Ashwood, Melbourne
VIC, 3147
Ph: 1300 131 531
Fax: 1300 308 508

Sales Offices

NSW	Sydney
QLD	Brisbane
SA	Adelaide
VIC	Melbourne
WA	Perth
NZ	Auckland

Distribution Centers

QLD	Brisbane
VIC	Melbourne
WA	Perth
NZ	Auckland



LubeWORKS
Solution for Lubricating Equipment

FuelWORKS
Solution for Fuel Transfer